

INDEX OF DOCUMENTS HELD ON THE PUBLIC REGISTER FOR PPL 188

1. 1 May 2001 Deed dated 1 May 2001 between the Minister for Minerals and Energy and:

Alliance Petroleum Australia Pty Ltd
Basin Oil Pty Ltd
Origin Energy Resources Limited
Bridge Oil Developments Pty Ltd
Delhi Petroleum Pty Ltd
Novus Australia Resources NL
Reef Oil Pty Ltd
Santos Ltd
Santos (BOL) Pty Ltd
Santos Petroleum Pty Ltd
Vamgas Pty Ltd

2. 15 May 2001 Grant of Licence

3. 15 May 2001 Memorandum entering Petroleum Production Licence PPL 188 on the Public Register

Interests in the Licence are as follows:

	%
Santos Ltd	40.70
Delhi Petroleum Pty Ltd	20.21
Origin Energy Resources Ltd	13.19
Vamgas Pty Ltd	8.51
Novus Australia Resources NL	4.75
Bridge Oil Developments Pty Ltd	3.99
Alliance Petroleum Australia Pty Ltd	3.97
Basin Oil NL	2.10
Reef Oil Pty Ltd	1.97
Santos Petroleum Pty Ltd	0.40
Santos (BOL) Pty Ltd	0.21

4. 31 May 2001 Gazettal of grant of PPL 188 published in SA Government Gazette dated 31 May 2001, Page 1906.

5. 15 October 2002 Certificate of Registration on Change of Type and Conversion to a Proprietary Company dated 8 June 2000:
From: Basin Oil NL
To: Basin Oil Pty Ltd

6. 15 October 2002 Memorandum entering change of company name on the Public Register.

7. 7 May 2004 Memorandum dated 7 May 2004 entering notation of adoption of the register for PELs 5&6 as part of the Commercial Register.

8. 23 July 2004 Memorandum entering notation of registrable dealing on the public register:
 - DPPL Security dated 21 May 2004 between Delhi Petroleum Pty Ltd and Westpac Banking Corporation Ref:SA 2004-44
9. 23 November 2005 Notation of discharge of security and receipt of replacement security is entered on the public register.
10. 21 December 2005 Deed to Amend Fixed Factor Area Deeds dated 24 October 2005 between the Minister for Mineral Resources Development and:

Alliance Petroleum Australia Pty Ltd
Basin Oil Pty Ltd
Origin Energy Resources Limited
Bridge Oil Developments Pty Ltd
Delhi Petroleum Pty Ltd
Novus Australia Resources NL
Reef Oil Pty Ltd
Santos Limited
Santos (BOL) Pty Ltd
Santos Petroleum Pty Ltd
Vamgas Pty Ltd
11. 13 January 2006 Memorandum entering change of name on the public register:

From: Novus Australia Resources NL
To: Santos (NARNL Cooper) NL
12. 9 May 2006 Memorandum entering change of name on the public register:

From: Santos (NARNL Cooper) NL
To: Santos (NARNL Cooper) Pty Ltd
13. 8 September 2009 Partial surrender, consolidation with PPL 34 (now PPL 234) and revocation of licence.
14. 8 September 2009 Memorandum entering partial surrender, consolidation and revocation on the public register.
15. 10 September 2009 Gazettal of Partial Surrender

PETROLEUM ACT 2000

Partial Surrender of Petroleum Production Licences and Grant of Petroleum Production Licences

NOTICE is hereby given that, pursuant to section 89 of the Petroleum Act 2000, I have accepted partial surrender of the following Petroleum Production Licence areas, pursuant to delegated powers dated 28 March 2002, *Gazetted* 11 April 2002, page 1573:

No. of Licence	Licensees	Locality	Effective Date of Surrender	Approx. Area Surrendered (km ²)	Reference
PPL 141	Santos Ltd Delhi Petroleum Pty Ltd Origin Energy Resources Limited Vamgas Pty Ltd Santos (NARNL Cooper) Pty Ltd Bridge Oil Developments Pty Ltd Alliance Petroleum Aust Pty Ltd Basin Oil Pty Ltd Reef Oil Pty Ltd Santos Petroleum Pty Ltd Santos (BOL) Pty Ltd	Cooper Basin of South Australia	1 July 2008	34.5	28/1/306
PPL 143				76.4	28/1/259
PPL 173				120.3	28/1/325
PPL 183				3.6	28/1/299
PPL 188				2.9	28/1/290
PPL 172				109.1	28/1/328
PPL 189				252.3	28/1/317
PPL 198				17.6	28/1/321
PPL 142	Vamgas Pty Ltd Santos Ltd	Cooper Basin of South Australia	1 July 2008	21.8	28/1/311
PPL 200	Delhi Petroleum Pty Ltd Origin Energy Resources Ltd Santos (NARNL Cooper) Pty Ltd		8 Sept. 2009	0.9	28/1/336

Grant of Petroleum Production Licences

Notice is hereby given that, pursuant to section 92 (1) of the Petroleum Act 2000, the undermentioned Petroleum Production Licences have been granted with effect from 8 September 2009, under the provisions of the Petroleum Act 2000, pursuant to delegated powers dated 28 March 2002, *Gazetted* 11 April 2002, page 1573.

No. of Licence	Licensees	Locality	Area (km ²)	Reference
PPL 228 (<i>ex PPLs 141, 96, 97</i>)	Santos Ltd Delhi Petroleum Pty Ltd Origin Energy Resources Limited Vamgas Pty Ltd Santos (NARNL Cooper) Pty Ltd Bridge Oil Developments Pty Ltd Alliance Petroleum Aust Pty Ltd Basin Oil Pty Ltd Reef Oil Pty Ltd Santos Petroleum Pty Ltd Santos (BOL) Pty Ltd	Cooper Basin of South Australia	96.04	28/1/435
PPL 230 (<i>ex PPLs 143, 157</i>)			7.0	28/1/437
PPL 231 (<i>ex PPLs 173, 71</i>)			33.42	28/1/438
PPL 232 (<i>ex PPLs 173, 85</i>)			3.99	28/1/439
PPL 233 (<i>ex PPLs 183, 28</i>)			27.18	28/1/440
PPL 234 (<i>ex PPLs 188, 34</i>)			22.64	28/1/441
PPL 235 (<i>ex PPLs 172, 82</i>)			6.38	28/1/442
PPL 236 (<i>ex PPLs 172, 189</i>)			1.87	28/1/443
PPL 237 (<i>ex PPLs 198, 93</i>)			14.4	28/1/444
PPL 238 (<i>ex PPLs 170, 49, 50</i>)			35.38	28/1/445
PPL 229 (<i>ex PPLs 142, 200</i>)			Vamgas Pty Ltd Santos Ltd Delhi Petroleum Pty Ltd Origin Energy Resources Ltd Santos (NARNL Cooper) Pty Ltd	

*Description of Areas**PPL 228*

All that part of the State of South Australia, bounded as follows:

Commencing at a point being the intersection of latitude 27°59'55"S GDA94 and longitude 140°55'25"E GDA94, thence east to longitude 140°56'35"E GDA94, south to latitude 28°01'50"S GDA94, east to longitude 140°57'20"E GDA94, north to latitude 28°01'00"S GDA94, east to longitude 140°57'50"E GDA94, north to latitude 28°00'40"S GDA94, east to longitude 140°58'05"E GDA94, north to latitude 28°00'00"S AGD66, east to longitude 140°59'10"E AGD66, south to latitude 28°02'10"S AGD66, thence east to the eastern border of the State of South Australia, thence southerly along the border of the said State to latitude 28°06'00"S Clarke1858, west to longitude 140°56'00"E Clarke1858, north to latitude 28°05'00"S Clarke1858, west to longitude 140°54'00"E Clarke1858, north to latitude 28°03'00"S Clarke1858, west to longitude 140°51'35"E GDA94, north to latitude 28°02'20"S GDA94, east to longitude 140°52'30"E GDA94, north to latitude 28°02'10"S GDA94, east to longitude 140°53'10"E GDA94, north to latitude 28°01'25"S AGD66, east to longitude 140°53'30"E AGD66, north to latitude 28°00'55"S GDA94, east to longitude 140°54'05"E GDA94, north to latitude 28°00'40"S GDA94, east to longitude 140°55'00"E GDA94, north to latitude 28°00'20"S GDA94, east to longitude 140°55'25"E GDA94 and north to point of commencement.

Area: 96.04 km² approximately.

PPL 229

All that part of the State of South Australia, bounded as follows:

Commencing at a point being the intersection of latitude 27°20'50"S GDA94 and longitude 140°14'10"E GDA94, thence east to longitude 140°14'35"E GDA94, south to latitude 27°20'55"S GDA94, east to longitude 140°14'45"E GDA94, south to latitude 27°21'20"S GDA94, east to longitude 140°15'25"E GDA94, south to latitude 27°21'40"S GDA94, west to longitude 140°15'15"E GDA94, south to latitude 27°22'00"S GDA94, west to longitude 140°15'05"E GDA94, south to latitude 27°22'05"S GDA94, west to longitude 140°14'40"E GDA94, north to latitude 27°22'00"S GDA94, west to longitude 140°14'05"E GDA94, south to latitude 27°22'15"S GDA94, west to longitude 140°13'50"E GDA94, south to latitude 27°22'30"S GDA94, west to longitude 140°13'45"E GDA94, south to latitude 27°22'45"S GDA94, west to longitude 140°13'40"E GDA94, south to latitude 27°22'55"S GDA94, west to longitude 140°13'05"E GDA94, north to latitude 27°22'30"S GDA94, east to longitude 140°13'15"E GDA94, north to latitude 27°22'20"S GDA94, east to longitude 140°13'20"E AGD66, north to latitude 27°21'50"S AGD66, east to longitude 140°13'30"E AGD66, north to latitude 27°21'40"S AGD66, east to longitude 140°13'40"E AGD66, north to latitude 27°20'55"S GDA94, east to longitude 140°14'10"E GDA94 and north to point of commencement.

Area: 6.78 km² approximately.

PPL 230

All that part of the State of South Australia, bounded as follows:

Commencing at a point being the intersection of latitude 28°09'50"S GDA94 and longitude 139°55'45"E GDA94, thence east to longitude 139°56'00"E GDA94, south to latitude 28°10'00"S GDA94, east to longitude 139°56'10"E GDA94, south to latitude 28°10'50"S GDA94, west to longitude 139°56'00"E GDA94, south to latitude 28°11'25"S GDA94, west to longitude 139°55'50"E GDA94, south to latitude 28°11'50"S AGD66, west to longitude 139°55'30"E AGD66, south to latitude 28°12'00"S AGD66, west to longitude 139°55'20"E AGD66, south to latitude 28°12'10"S AGD66, west to longitude 139°55'10"E AGD66, south to latitude 28°12'20"S AGD66, west to longitude 139°54'30"E AGD66, north to latitude 28°12'00"S AGD66, east to longitude 139°54'40"E AGD66, north to latitude 28°11'50"S AGD66, east to longitude 139°54'50"E AGD66, north to latitude 28°11'00"S AGD66, west to longitude 139°54'40"E GDA94, north to latitude 28°10'35"S GDA94, east to longitude 139°55'00"E GDA94, north to latitude 28°10'25"S GDA94, east to longitude 139°55'15"E GDA94, north to latitude 28°10'15"S GDA94, east to longitude 139°55'20"E GDA94, north to latitude 28°10'00"S GDA94, east to longitude 139°55'45"E GDA94 and north to point of commencement.

Area: 7 km² approximately.

PPL 231

All that part of the State of South Australia, bounded as follows:

Commencing at a point being the intersection of latitude 28°12'00"S GDA94 and longitude 140°57'10"E GDA94, thence east to longitude 140°57'35"E GDA94, south to latitude 28°12'10"S GDA94, east to longitude 140°58'10"E GDA94, south to latitude 28°12'20"S GDA94, east to longitude 140°59'00"E GDA94, south to latitude 28°13'10"S AGD66, east to longitude 140°59'10"E AGD66, south to latitude 28°13'30"S AGD66, east to longitude 140°59'30"E AGD66, south to latitude 28°14'20"S GDA94, east to longitude 140°59'45"E GDA94, south to latitude 28°15'30"S GDA94, thence east to eastern border of the State of South Australia, thence southerly along the border of the said State to latitude 28°17'35"S GDA94, west to longitude 140°59'40"E GDA94, south to latitude 28°17'40"S GDA94, west to longitude 140°58'25"E GDA94, north to latitude 28°17'35"S GDA94, west to longitude 140°58'15"E GDA94, north to latitude 28°16'40"S GDA94, west to longitude 140°58'05"E GDA94, north to latitude 28°16'05"S GDA94, west to longitude 140°57'50"E GDA94, north to latitude 28°15'25"S GDA94, west to longitude 140°57'45"E GDA94, north to latitude 28°15'15"S GDA94, west to longitude 140°57'40"E GDA94, north to latitude 28°15'10"S AGD66, west to longitude 140°57'20"E AGD66, north to latitude 28°14'50"S AGD66, west to longitude 140°57'10"E AGD66, north to latitude 28°12'40"S GDA94, west to longitude 140°57'10"E GDA94 and north to point of commencement.

Area: 33.42 km² approximately.

PPL 232

All that part of the State of South Australia, bounded as follows:

Commencing at a point being the intersection of latitude 28°14'10"S AGD66 and longitude 140°56'10"E AGD66, thence east to longitude 140°56'50"E AGD66, south to latitude 28°14'20"S AGD66, east to longitude 140°57'10"E AGD66, south to latitude 28°14'50"S AGD66, east to longitude 140°57'20"E AGD66, south to latitude 28°15'10"S AGD66, west to longitude 140°57'10"E AGD66, south to latitude 28°15'20"S AGD66, west to longitude 140°57'00"E AGD66, south to latitude 28°15'30"S AGD66, west to longitude 140°56'20"E AGD66, north to latitude 28°15'20"S AGD66, west to longitude 140°56'10"E AGD66, north to latitude 28°15'00"S AGD66, west to longitude 140°56'10"E GDA94, north to latitude 28°14'25"S AGD66, east to longitude 140°56'10"E AGD66 and north to the point of commencement.

Area: 3.99 km² approximately.

PPL 233

All that part of the State of South Australia, bounded as follows:

Commencing at a point being the intersection of latitude 27°46'10"S AGD66 and longitude 139°57'20"E AGD66, thence east to longitude 139°58'20"E AGD66, south to latitude 27°47'00"S AGD66, east to longitude 139°59'00"E AGD66, south to latitude 27°47'10"S AGD66, east to longitude 139°59'20"E AGD66, south to latitude 27°47'20"S AGD66, east to longitude 139°59'40"E AGD66, south to latitude 27°47'30"S AGD66, east to longitude 140°00'00"E Clarke1858, south to latitude 27°49'00"S AGD66, west to longitude 139°58'50"E AGD66, north to latitude 27°48'50"S AGD66, west to longitude 139°58'30"E AGD66, south to latitude 27°49'00"S AGD66, east to longitude 139°58'40"E AGD66, south to latitude 27°49'20"S AGD66, east to longitude 139°59'00"E AGD66, south to latitude 27°49'40"S GDA94, west to longitude 139°56'50"E AGD66, north to latitude 27°48'30"S AGD66, west to longitude 139°56'10"E AGD66, north to latitude 27°47'30"S AGD66, east to longitude 139°56'30"E AGD66, north to latitude 27°47'10"S AGD66, east to longitude 139°56'50"E AGD66, north to latitude 27°46'50"S AGD66, east to longitude 139°57'20"E AGD66 and north to the point of commencement.

Area: 27.18 km² approximately.

PPL 234

All that part of the State of South Australia, bounded as follows:

Commencing at a point being the intersection of latitude 28°26'50"S AGD66 and longitude 140°28'50"E AGD66, thence east to longitude 140°29'40"E AGD66, south to latitude 28°27'00"S AGD66, east to longitude 140°30'00"E AGD66, south to latitude 28°27'10"S AGD66, east to longitude 140°30'20"E AGD66, south to latitude 28°28'20"S AGD66, east to longitude 140°30'40"E GDA94, south to latitude 28°28'40"S AGD66, west to longitude 140°29'55"E AGD66, south to latitude 28°29'00"S Clarke1858, east to longitude 140°30'00"E Clarke1858, south to latitude 28°29'15"S AGD66, west to longitude 140°29'10"E AGD66, south to latitude 28°29'30"S AGD66, west to longitude 140°28'15"E AGD66, north to latitude 28°28'55"S AGD66, west to longitude 140°27'40"E AGD66, south to latitude 28°29'10"S AGD66, west to longitude 140°27'10"E AGD66, north to latitude 28°29'05"S AGD66, west to longitude 140°26'35"E AGD66, north to latitude 28°28'10"S GDA94, east to longitude 140°26'45"E GDA94, north to latitude 28°28'05"S GDA94, east to longitude 140°26'50"E AGD66, north to latitude 28°27'30"S AGD66, east to longitude 140°27'20"E AGD66, north to latitude 28°27'00"S AGD66, east to longitude 140°28'20"E AGD66, south to latitude 28°27'20"S AGD66, east to longitude 140°28'40"E AGD66, south to latitude 28°27'25"S AGD66, east to longitude 140°28'50"E AGD66 and north to the point of commencement.

Area: 22.64 km² approximately.

PPL 235

All that part of the State of South Australia, bounded as follows:

Commencing at a point being the intersection of latitude 28°21'15"S GDA94 and longitude 140°04'00"E Clarke1858, thence east to longitude 140°04'05"E GDA94, south to latitude 28°21'20"S GDA94, east to longitude 140°04'15"E GDA94, south to latitude 28°21'25"S GDA94, east to longitude 140°04'20"E GDA94, south to latitude 28°21'30"S GDA94, east to longitude 140°04'25"E GDA94, south to latitude 28°21'35"S GDA94, east to longitude 140°04'30"E GDA94, south to latitude 28°21'50"S AGD66, east to longitude 140°04'52"E GDA94, north to latitude 28°21'40"S GDA94, east to longitude 140°04'57"E GDA94, north to latitude 28°21'35"S GDA94, east to longitude 140°05'07"E GDA94, south to latitude 28°21'40"S GDA94, east to longitude 140°05'12"E GDA94, south to latitude 28°21'50"S AGD66, east to longitude 140°05'50"E AGD66, south to latitude 28°22'40"S AGD66, west to longitude 140°04'20"E AGD66, south to latitude 28°23'10"S AGD66, west to longitude 140°04'00"E Clarke1858 and north to the point of commencement.

Area: 6.38 km² approximately.

PPL 236

All that part of the State of South Australia, bounded as follows:

Commencing at a point being the intersection of latitude 28°22'50"S AGD66 and longitude 140°16'40"E GDA94, thence east to longitude 140°17'05"E GDA94, south to latitude 28°23'00"S AGD66, east to longitude 140°17'30"E AGD66, south to latitude 28°23'10"S GDA94, west to longitude 140°17'20"E GDA94, south to latitude 28°23'40"S AGD66, west to longitude 140°16'30"E AGD66, north to latitude 28°23'10"S AGD66, east to longitude 140°16'40"E GDA94 and north to the point of commencement.

Area: 1.87 km² approximately.

PPL 237

All that part of the State of South Australia, bounded as follows:

Commencing at a point being the intersection of latitude 28°02'40"S AGD66 and longitude 140°46'20"E AGD66, thence east to longitude 140°46'40"E AGD66, south to latitude 28°03'10"S AGD66, west to longitude 140°46'30"E AGD66, south to latitude 28°03'20"S AGD66, west to longitude 140°45'50"E AGD66, south to latitude 28°03'30"S AGD66, west to longitude 140°45'45"E GDA94, south to latitude 28°04'00"S GDA94, west to longitude 140°45'15"E GDA94, south to latitude 28°04'20"S GDA94, west to longitude 140°44'15"E GDA94, north to latitude 28°04'10"S GDA94, west to longitude 140°43'40"E GDA94, south to latitude 28°04'30"S GDA94, west to longitude 140°43'25"E GDA94, south to latitude 28°04'40"S GDA94, west to longitude 140°43'00"E Clarke1858, north to latitude 28°03'00"S AGD66, east to longitude 140°44'00"E AGD66, north to latitude 28°02'50"S AGD66, east to longitude 140°46'20"E AGD66 and north to the point of commencement.

Area: 14.4 km² approximately.

PPL 238

All that part of the State of South Australia, bounded as follows:

Commencing at a point being the intersection of latitude 27°43'20"S AGD66 and longitude 139°56'50"E AGD66, thence east to longitude 139°58'30"E AGD66, south to latitude 27°43'30"S AGD66, east to longitude 139°59'20"E AGD66, south to latitude 27°43'50"S AGD66, east to longitude 139°59'40"E AGD66, south to latitude 27°45'00"S Clarke1858, west to longitude 139°58'40"E AGD66, south to latitude 27°45'20"S AGD66, west to longitude 139°58'30"E AGD66, south to latitude 27°45'30"S AGD66, west to longitude 139°58'20"E AGD66, south to latitude 27°45'40"S AGD66, west to longitude 139°58'00"E AGD66, north to latitude 27°45'30"S AGD66, west to longitude 139°57'40"E AGD66, south to latitude 27°45'50"S AGD66, west to longitude 139°57'10"E AGD66, south to latitude 27°46'00"S AGD66, west to longitude 139°56'30"E AGD66, south to latitude 27°46'30"S AGD66, west to longitude 139°55'30"E AGD66, north to latitude 27°46'10"S AGD66, west to longitude 139°54'50"E AGD66, south to latitude 27°46'20"S AGD66, west to longitude 139°53'50"E AGD66, north to latitude 27°45'10"S AGD66, east to

longitude 139°54'00"E AGD66, north to latitude 27°45'00"S Clarke1858, east to longitude 139°54'10"E AGD66, north to latitude 27°44'40"S AGD66, east to longitude 139°54'20"E AGD66, north to latitude 27°44'30"S AGD66, east to longitude 139°55'20"E AGD66, north to latitude 27°44'20"S AGD66, east to longitude 139°55'50"E AGD66, south to latitude 27°44'30"S AGD66, east to longitude 139°56'10"E AGD66, north to latitude 27°43'30"S AGD66, east to longitude 139°56'50"E AGD66 and north to the point of commencement.

Area: 35.38 km² approximately.

Dated 8 September 2009.

B. A. GOLDSTEIN,
Director Petroleum and Geothermal
Minerals and Energy Resources
Primary Industries and Resources SA
Delegate of the Minister for Mineral Resources Development

**Petroleum Act 2000
S.115**

MEMORANDUM

**PETROLEUM PRODUCTION LICENCES
PPL 188, PPL 34, PPL 234**

1. Partial surrender of PPL 188, with effect from 1 July 2008;
2. Revocation of Condition 4 of PPL 188;
3. Consolidation of PPL 188 and PPL 34 (now PPL 234);
4. Grant of Petroleum Production Licence PPL 234; and
5. Revocation of PPL 188 and PPL 34

is hereby entered on the public registers.

Holder: Santos Ltd
Delhi Petroleum Pty Ltd
Origin Energy Resources Limited
Vamgas Pty Ltd
Santos (NARNL Cooper) Pty Ltd
Bridge Oil Developments Pty Ltd
Alliance Petroleum Australia Pty Ltd
Basin Oil Pty Ltd
Reef Oil Pty Ltd
Santos Petroleum Pty Ltd
Santos (BOL) Pty Ltd



**BARRY A. GOLDSTEIN
Director Petroleum and Geothermal
Minerals and Energy Resources
Primary Industries and Resources SA
Delegate of the Minister for Mineral Resources
Development**

Date: 8 September 2009

Ref: 28/1/290
28/1/103
28/1/441

Petroleum Act 2000

PARTIAL SURRENDER, REVOCATION OF CONDITION, PETROLEUM PRODUCTION LICENCE PPL 188

CONSOLIDATION OF LICENCE AREAS PETROLEUM PRODUCTION LICENCES PPL 188 and PPL 34

I, BARRY ALAN GOLDSTEIN, Director Petroleum and Geothermal, Minerals and Energy Resources, Department of Primary Industries and Resources, in the State of South Australia, pursuant to the provisions of the *Petroleum Act 2000* (the Act) and all other enabling powers, for and on behalf of Paul Holloway, Minister for Mineral Resources Development (Minister), pursuant to delegated powers –

1. in fulfilment of Condition 4 of Petroleum Production Licence PPL 188 hereby accept partial surrender of PPL 188, pursuant to section 89 of the Act, with effect from 1 July 2008.

The total area of PPL 188 is reduced to 13.2 square kilometres approximately, as a result of partial surrender of the licence area.

2. hereby revoke Condition 4 of the licence conditions of PPL 188 pursuant to section 76 (3) (b) of the Act, following the fulfilment of the conditions of the Deed dated 1 May 2001, subsequently amended by Deed to Amend Fixed Factor Area Deeds dated 24 October 2005.
3. pursuant to section 82 of the Act, hereby consolidate the adjacent areas of Petroleum Production Licences PPL 188 and PPL 34, so forming Petroleum Production Licence PPL 234 as a new licence in continuity of PPL 188 and PPL 34.

As a consequence of this consolidation, PPL 188 and PPL 34 are hereby revoked.

Date: 8 September 2009



BARRY A. GOLDSTEIN
Director Petroleum and Geothermal
Minerals and Energy Resources
Primary Industries and Resources SA
Delegate of the Minister for Mineral Resources Development

The following signatures evidence the consent of the licensees to:

- a. the revocation of Condition 4 of the conditions of PPL 188;
- b. the consolidation of the retained area of PPL 188 and PPL 34, to be known as PPL 234.

Executed for and on behalf of:

**Santos Ltd
Vamgas Pty Ltd,
Santos Petroleum Pty Ltd,
Bridge Oil Developments Pty Ltd
Santos (BOL) Pty Ltd
Reef Oil Pty Ltd
Alliance Petroleum Australia Pty Ltd
Santos (NARNL Cooper) Pty Ltd
Basin Oil Pty Ltd**

by its duly appointed attorney:

Demitra Ritossa

.....
Name (print)

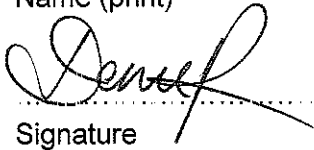
.....
Signature

Signed for and on behalf of **Delhi Petroleum Pty Ltd** by its authorised representative:

**Gordon Moseby
Production Manager**

.....
Name (print)

.....
Signature

Signed for and on behalf of **Origin Energy Resources Ltd** by its ~~authorised representative:~~ *duly appointed attorney:*
Owen Hobbs

**Eastern Australia Onshore Asset Manager
Upstream Oil & Gas Australia**

.....
Name (print)

.....
Signature

Petroleum Act 2000
S.115

MEMORANDUM

Petroleum Production Licences (PPLs) 6, 7, 8, 9, 10, 11, 12, 13, 14, 15, 16, 17, 18, 19, 20, 22, 23, 24, 25, 26, 27, 28, 29, 30, 31, 32, 33, 34, 35, 36, 37, 38, 39, 40, 41, 42, 43, 44, 45, 46, 47, 48, 49, 50, 51, 52, 53, 54, 55, 56, 57, 58, 59, 60, 61, 63, 64, 65, 66, 67, 68, 69, 70, 71, 72, 73, 74, 75, 76, 77, 78, 79, 80, 81, 82, 83, 84, 85, 86, 87, 88, 89, 90, 91, 92, 93, 94, 95, 96, 97, 98, 99, 100, 101, 102, 103, 104, 105, 106, 107, 108, 109, 110, 111, 112, 113, 114, 115, 116, 117, 118, 119, 120, 121, 122, 123, 124, 125, 126, 127, 128, 129, 130, 131, 132, 133, 134, 135, 136, 137, 138, 139, 140, 141, 142, 143, 144, 145, 146, 147, 148, 149, 150, 151, 152, 153, 154, 155, 156, 157, 158, 159, 160, 161, 162, 163, 164, 165, 166, 167, 169, 170, 171, 172, 173, 174, 175, 176, 177, 178, 179, 180, 181, 182, 183, 184, 185, 186, 187, 188, 189, 190, 191, 192, 193, 194, 195, 196, 197, 198, 199 and Pipeline Licence (PL) 2.

1. Notation of change of company name –

From: Santos (NARNL Cooper) NL
To: Santos (NARNL Cooper) Pty Ltd

is hereby entered on the public register of licences.



C. D. COCKSHELL
A/Director Petroleum and Geothermal
Minerals and Energy Resources
Primary Industries and Resources SA
Delegate of the Minister for Mineral Resources
Development

Date: 9 May 2006

File: 27/2/4

General Counsel
06 DEC 2005
Legal Services/
Group Secretariat

Form 242

Santos Limited Attn: Graham Bollenhagen
GPO Box 2455
Adelaide SA 5001

Remove this top section if desired before framing

Certificate of Registration on Change of Type and Conversion to a Proprietary Company



This is to certify that

SANTOS (NARNL COOPER) NL

Australian Company Number 004 761 255

on the first day of December 2005 converted to
a **company limited by shares**
and on the first day of December 2005 changed to
a **proprietary** company.

The name of the company is now

SANTOS (NARNL COOPER) PTY LTD

Australian Company Number 004 761 255

The company is taken to be registered under the Corporations
Act 2001 in Victoria and the date of commencement of
registration is the twenty-first day of February, 1969.

Issued by the
Australian Securities and Investments Commission
on this first day of December, 2005.

Jeffrey Lucy
Chairman

CERTIFICATE

Petroleum Act 2000
S.115

MEMORANDUM

Petroleum Production Licences (PPLs) 6, 7, 8, 9, 10, 11, 12, 13, 14, 15, 16, 17, 18, 19, 20, 22, 23, 24, 25, 26, 27, 28, 29, 30, 31, 32, 33, 34, 35, 36, 37, 38, 39, 40, 41, 42, 43, 44, 45, 46, 47, 48, 49, 50, 51, 52, 53, 54, 55, 56, 57, 58, 59, 60, 61, 63, 64, 65, 66, 67, 68, 69, 70, 71, 72, 73, 74, 75, 76, 77, 78, 79, 80, 81, 82, 83, 84, 85, 86, 87, 88, 89, 90, 91, 92, 93, 94, 95, 96, 97, 98, 99, 100, 101, 102, 103, 104, 105, 106, 107, 108, 109, 110, 111, 112, 113, 114, 115, 116, 117, 118, 119, 120, 121, 122, 123, 124, 125, 126, 127, 128, 129, 130, 131, 132, 133, 134, 135, 136, 137, 138, 139, 140, 141, 142, 143, 144, 145, 146, 147, 148, 149, 150, 151, 152, 153, 154, 155, 156, 157, 158, 159, 160, 161, 162, 163, 164, 165, 166, 167, 169, 170, 171, 172, 173, 174, 175, 176, 177, 178, 179, 180, 181, 182, 183, 184, 185, 186, 187, 188, 189, 190, 191, 192, 193, 194, 195, 196, 197, 198, 199 and Pipeline Licence (PL) 2.

1. Notation of change of company name –

From: Novus Australia Resources NL
To: Santos (NARNL Cooper) NL

is hereby entered on the public register of licences.



BARRY A. GOLDSTEIN
Director Petroleum
Minerals and Energy Resources
Primary Industries and Resources SA
Delegate of the Minister for Mineral Resources
Development

Date: 13 January 2006

File: 27/2/4

Santos Limited Attn: Graham Bollenhagen
GPO Box 2455
Adelaide SA 5001

Remove this top section if desired before framing

Certificate of Registration on Change of Name



This is to certify that

NOVUS AUSTRALIA RESOURCES NL

Australian Company Number 004 761 255

did on the twenty-ninth day of June 2005 change its name to

SANTOS (NARNL COOPER) NL

Australian Company Number 004 761 255

The company is a public company.

The company is a no liability company.

The company is taken to be registered under the Corporations Act 2001 in Victoria and the date of commencement of registration is the twenty-first day of February, 1969.

Issued by the
Australian Securities and Investments Commission
on this twenty-ninth day of June, 2005.

Jeffrey Lucy
Chairman

CERTIFICATE

Petroleum Act 2000
S.115

MEMORANDUM

PETROLEUM PRODUCTION LICENCES

PPLs 138, 140, 141, 143, 145, 148, 150, 151, 153, 169, 170, 171, 172, 173, 174, 175, 176, 177, 178, 179, 180, 181, 183, 184, 185, 186, 188, 189, 190, 192, 193, 195, 196, 198 and 199.

1. The following Deed is entered on the Public Register:

Deed to Amend Fixed Factor Area Deeds dated 24th October 2005 between the Minister for Mineral Resources Development, Alliance Petroleum Australia Pty Ltd, Basin Oil Pty Ltd, Origin Energy Resources Limited, Bridge Oil Developments Pty Ltd, Delhi Petroleum Pty Ltd, Novus Australia Resources NL (now Santos (NARL Cooper) NL), Reef Oil Pty Ltd, Santos Limited, Santos (BOL) Pty Ltd, Santos Petroleum Pty Ltd and Vamgas Pty Ltd.

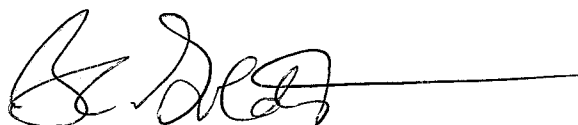

BARRY A. GOLDSTEIN
Director Petroleum
Minerals and Energy Resources
Primary Industries and Resources SA
Delegate of the Minister for Mineral Resources
Development

Date: 21 December 2005

SR 27/2/4

DATED

24th

DAY OF

OCTOBER

2005

DEED TO AMEND FIXED FACTOR AREA DEEDS

BETWEEN

**MINISTER FOR MINERAL RESOURCES DEVELOPMENT
("MINISTER")**

-AND-

**ALLIANCE PETROLEUM AUSTRALIA PTY LTD
A.B.N. 60 004 559 951**

**BASIN OIL PTY LTD
A.B.N. 36 000 628 017**

**ORIGIN ENERGY RESOURCES LIMITED
A.B.N. 66 007 845 338**

**BRIDGE OIL DEVELOPMENTS PTY LTD
A.B.N. 30 001 152 049**

**DELHI PETROLEUM PTY LTD
A.B.N. 65 007 854 686**

**NOVUS AUSTRALIA RESOURCES NL
A.B.N. 75 004 761 255**

**REEF OIL PTY LTD
A.B.N. 70 000 646 800**

**SANTOS LIMITED
A.B.N. 80 007 550 923**

**SANTOS (BOL) PTY LTD
A.B.N. 35 000 146 575**

**SANTOS PETROLEUM PTY LTD
A.B.N. 95 000 146 369**

**VAMGAS PTY LTD
A.B.N. 76 006 245 110**

("LICENSEES")



CROWN SOLICITOR

Level 9, 45 Pirie Street, Adelaide SA 5000

TABLE OF CONTENTS

1. ACCURACY OF RECITALS.....2

2. DEFINITIONS & INTERPRETATION2

3. AMENDMENT TO GREATER BECKLER AREA DEED4

4. AMENDMENT TO CABERNET DEED4

5. AMENDMENT TO ALLAMBI DEED4

6. AMENDMENT TO ATREIDES DEED4

7. COSTS5

8. SUCCESSORS BOUND.....5

9. PROPER LAW AND JURISDICTION.....5

10. COUNTERPARTS5

11. ORIGINAL DEEDS5

THIS DEED is made the

24th

day of

October

2005

BETWEEN:

MINISTER FOR MINERAL RESOURCES DEVELOPMENT a body corporate pursuant to the Administrative Arrangements Act, 1994 (SA) and whose office is situated at Level 9, 178 North Terrace, Adelaide 5000 in the State of South Australia. ("Minister")

COMMISSIONER OF STATE TAXATION

STAMP DUTY PAID

ORIGINAL WITH 0 COPIES

21/12/2005 14:45:25

DEED

AND

ALLIANCE PETROLEUM AUSTRALIA PTY LTD A.B.N. 60 004 559 951 of Level 29, 91 King William Street, Adelaide, South Australia, **BASIN OIL PTY LTD** A.B.N. 36 000 628 017 of c/- OMV Australia Pty Ltd, Level 29 St Martins Tower, 44 St Georges Terrace, Perth, Western Australia, **ORIGIN ENERGY RESOURCES LIMITED** A.B.N. 66 007 845 338 of Level 2, South Tower John Oxley Centre, 339 Coronation Drive, Milton Queensland, **BRIDGE OIL DEVELOPMENTS PTY LTD** A.B.N. 30 001 152 049 of Level 29, 91 King William Street, Adelaide, South Australia, **DELHI PETROLEUM PTY LTD** A.B.N. 65 007 854 686 of c/- Gradav Ltd., 128 Crown Street, East Sydney, NSW, **NOVUS AUSTRALIA RESOURCES NL** A.B.N. 75 004 761 255 of Level 19, 321 Kent Street, Sydney, New South Wales, **REEF OIL PTY LTD** A.B.N. 70 000 646 800 of Level 29, 91 King William Street, Adelaide, South Australia, **SANTOS LIMITED** A.B.N. 80 007 550 923 of Level 29, 91 King William Street, Adelaide, South Australia, **SANTOS (BOL) PTY LTD** A.B.N. 35 000 670 575 of Level 29, 91 King William Street, Adelaide, South Australia, **SANTOS PETROLEUM PTY LTD** A.B.N. 000 146 369 of Level 29, 91 King William Street, Adelaide, South Australia, **VAMGAS PTY LTD** A.B.N. 006 245 100 of Level 29, 91 King William Street, Adelaide, South Australia ("Licensees")

RECITALS:

- A. By way of several deeds dated 23 July 1999, 12 June 2001, 1 May 2001, and 5 January 2000 between the Parties, the Parties agreed certain special conditions on Petroleum Production Licences ("PPL") that require that areas greater than twice the proved and probable area of the field, be surrendered by various agreed dates.

- B. Several of the special conditions on Petroleum Production Licences have been met. However, many of the special conditions on Petroleum Production Licences remain unmet.
- C. The parties now wish to record that certain Petroleum Production Licences referred to in this deed have met the special conditions set out in the Original Deeds and that other Petroleum Production Licences referred to in the Original Deeds have not met the special conditions set out in the Original Deeds and that the Original Deeds as they relate to the unmet special conditions are to be extended to 30 June 2008.

THE PARTIES COVENANT AS FOLLOWS:

1. ACCURACY OF RECITALS

The Parties agree both that the matters referred to in the recitals of this Deed are true and correct in every material particular and that the recitals shall form part of this Deed.

2. DEFINITIONS & INTERPRETATION

2.1 Definitions

Subject to any contrary intention indicated by subject or context, for the purpose of the interpretation of this Deed the following terms and expressions are stipulated as having the following meanings:

2.1.1 “**Petroleum Production Licence / PPL**” means either

- (a) a petroleum production licence granted to the Licensees by the Minister pursuant to *Petroleum Act, 1940* and other enabling legislation and continued pursuant to section 2 of the Schedule to the *Petroleum Act, 2000*, or
- (b) a petroleum production licence granted to the Licensees by the Minister pursuant to the *Petroleum Act, 2000*.

2.1.2 “**Licensee**” means Alliance Petroleum Australia Pty Ltd A.B.N 60 004 559 951, Basin Oil Pty Ltd A.B.N. 36 000 628 017, Origin Energy Resources Limited A.B.N. 66 007 845 338, Bridge Oil Developments Pty Ltd A.B.N. 30 001 152 049, Delhi Petroleum Pty Ltd A.B.N. 65 007 854

686, Novus Australia Resources NL A.B.N. 75 004 761 255, Reef Oil Pty Ltd A.B.N. 70 000 646 800, Santos Limited A.B.N. 80 007 550 923, Santos (BOL) Pty Ltd A.B.N. 35 000 670 575, Santos Petroleum Pty Ltd A.B.N. 000 146 369, Vamgas Pty Ltd A.B.N. 006 245 100

- 2.1.3 **"Parties"** means the parties to this deed.
- 2.1.4 **"Greater Beckler Area Deed"** means the deed between the Parties dated 5th January 2000 in relation to PPL141 named Greater Beckler.
- 2.1.5 **"Allambi Deed"** means the deed between the Parties dated 12th June 2001 in relation to PPL169 named Allambi Extension and other PPLs 170, 174, 176, 177, 178, 179, 180, 184, 193, 195 and 199.
- 2.1.6 **"Cabernet Deed"** means the deed between the Parties dated 23rd July 1999 in relation to PPL138 named Cabernet and other PPLs 143, 145, 151, 140, 150, 153 and 148.
- 2.1.7 **"Atreides Deed"** means the deed between the Parties dated 1st May 2001 in relation to PPL171 named Atriedes Extension and other PPLs 172, 173, 175, 181, 183, 185, 186, 188, 189, 190, 192, 196 and 198.
- 2.1.8 **"Original Deeds"** means the Greater Beckler Area Deed, the Allambi Deed, the Cabernet Deed and the Atreides Deed.

2.2 **Interpretation**

Subject to any contrary intention indicated by subject or context, the following rules of construction shall be used in the interpretation of this Deed.

- 2.2.1 Words denoting the singular number or plural number include the plural number and singular number respectively.
 - 2.2.2 Words denoting any gender shall include all genders.
 - 2.2.3 Headings are for convenience only and shall not affect interpretation.
 - 2.2.4 Words denoting individuals shall include corporations and vice versa.
 - 2.2.5 A reference to a recital, party, clause, schedule appendix or annexure is a reference to a recital, party, clause, schedule, appendix or annexure of this Deed.
 - 2.2.6 A reference to any Act, regulation or by-law shall be deemed to include all amendments thereto and all statutory provisions substituted hereafter.
 - 2.2.7 The use of "or" shall be that of the inclusive "or", i.e., meaning one, some or all of a number of possibilities or alternatives.
 - 2.2.8 All references to "dollars" or to "\$" are to Australian dollars.
-

3. AMENDMENT TO GREATER BECKLER AREA DEED

- 3.1 The Parties agree to amend the Greater Beckler Area Deed by deleting the words and figure “1 January 2005” where they appear in Column 4 of the Schedule and substituting in their place the words and figures “30 June 2008”.
- 3.2 The provision of this Deed will be read together with and form part of the Greater Beckler Area Deed.

4. AMENDMENT TO CABERNET DEED

- 4.1 The Parties agree to amend the Cabernet Deed by deleting the words and figures “5 years from Grant” where it appears in second, third, fifth and eighth lines of Column 4 of the Schedule to that Deed and in their place substituting the words and figures “30 June 2008”.
- 4.2 The Parties agree that PPLs 138, 150,151 and 153 referred to in the Cabernet Deed have met the special conditions referred to in the Cabernet Deed.
- 4.3 The provisions of this Deed will be read together with and form part of the Cabernet Deed.

5. AMENDMENT TO ALLAMBI DEED

- 5.1 The Parties agree to amend the Allambi Deed by deleting the words and figures “5 years from grant” where they appear in Column 4 of the Schedule to that Deed and substituting in their place the words and figures “30 June 2008”.
- 5.2 The provisions of this Deed will be read together with and form part of the Allambi Deed.

6. AMENDMENT TO ATREIDES DEED

- 6.1 The Parties agree to amend the Atreides Deed by deleting the words and figures “5 years from grant” where they appear in Column 4 of the Schedule to that Deed and substituting in their place the words and figures “30 June 2008”.
 - 6.2 The provisions of this Deed will be read together with and form part of the Atreides Deed.
-

7. **COSTS**

The Parties each bear their own legal costs and expenses incurred in respect of the negotiation, preparation and execution of this Deed. Further, the Licensee shall pay any stamp duty assessed in respect of this Deed.

8. **SUCCESSORS BOUND**

This Deed binds a party's successors, personal representatives and assigns.

9. **PROPER LAW AND JURISDICTION**

9.1 The laws in force in South Australia apply to this Deed.

9.2 The Parties agree to submit to the exclusive jurisdiction of the courts of South Australia in respect of all disputes arising under or relating to this Deed and any proceedings brought in the Federal Court must be instituted in the Adelaide Registry of the Federal Court.

10. **COUNTERPARTS**

This Deed may be executed in any number of counterparts each of which is taken to be an original. All of those counterparts taken together constitute one document.

11. **ORIGINAL DEEDS**

Except and to the extent that the Original Deeds are varied by this Deed the Original Deeds remain unchanged.

EXECUTED UNCONDITIONALLY AS A DEED

THE COMMON SEAL of the **MINISTER**

FOR MINERAL RESOURCES

DEVELOPMENT was hereunto affixed by

authority of the Minister in the presence of:



Saul Holloway

.....
Lee Bitzios

Witness

Print Name: *LEE BITZIOS*

Executed for and on behalf of **ALLIANCE PETROLEUM**

AUSTRALIA PTY LTD, BRIDGE OIL

DEVELOPMENTS PTY LTD, REEF OIL PTY

LTD, SANTOS LIMITED, SANTOS (BOL) PTY

LTD, SANTOS PETROLEUM PTY LTD and

VAMGAS PTY LTD respectively by being **SIGNED,**

SEALED AND DELVERED by its duly appointed

Attorney in the presence of:

.....
Diane Gibson

Witness

Print Name: *DIANE GIBSON*

[Signature]

THE COMMON SEAL of BASIN OIL PTY LTD)

was hereunto affixed in the presence of:)

Peter C Wasow

Director
Print Name: **PETER C WASOW**

Robert James Wishart

Secretary
Print Name: **ROBERT JAMES WISHART**



THE COMMON SEAL of ORIGIN ENERGY)

RESOURCES LTD was hereunto affixed in the presence)
of:)

Robert Jan Willink

Director
Print Name: **DIRECTOR
ROBERT JAN WILLINK**

Bruce John Atkinson

Secretary
Print Name: **Bruce John Atkinson**



EXECUTED for and on behalf of **DELHI**)

PETROLEUM PTY LTD by its duly)

authorised attorney in the presence of:)

.....
Signature of Witness

.....
Signature of Attorney

.....
Name of Witness

.....
Name of Attorney

DPPL

EXECUTED by **DELHI**)
PETROLEUM PTY LTD in)
Accordance with section 127(1) of the)
Corporations Act by authority of its)
Directors:)

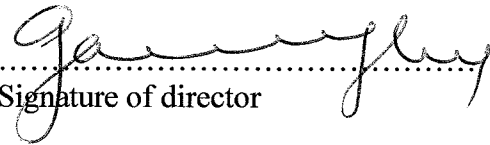
.....
Signature of director)

G. S. FOLEY
.....
Name of director (block letters))

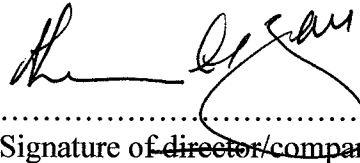
.....
Signature of ~~director~~/company)
secretary*)
*delete whichever is not applicable

K. C. BAK
.....
Name of ~~director~~/company secretary*)
*delete whichever is not applicable

THE COMMON SEAL of **NOVUS AUSTRALIA**)

RESOURCES N.L. was hereunto affixed in accordance)

its constitution in the presence of:)

[Handwritten signature]

.....
Director
Print Name: **PETER C WASOW**

[Handwritten signature]

.....
Secretary
Print Name: **ROBERT JAMES WISHART**



Petroleum Act 2000
S.115

MEMORANDUM

PETROLEUM PRODUCTION LICENCES (PPLs) 6, 7, 8, 9, 10, 11, 12, 13, 14, 15, 16, 17, 18, 19, 20, 22, 23, 24, 25, 26, 27, 28, 29, 30, 31, 32, 33, 34, 35, 36, 37, 38, 39, 40, 41, 42, 43, 44, 45, 46, 47, 48, 49, 50, 51, 52, 53, 54, 55, 56, 57, 58, 59, 60, 61, 63, 64, 65, 66, 67, 68, 69, 70, 71, 72, 73, 74, 75, 76, 77, 78, 79, 80, 81, 82, 83, 84, 85, 86, 87, 88, 89, 90, 91, 92, 93, 94, 95, 96, 97, 98, 99, 100, 101, 102, 103, 104, 105, 106, 107, 108, 109, 110, 111, 113, 114, 115, 116, 117, 118, 119, 120, 121, 122, 123, 124, 125, 126, 127, 128, 129, 130, 131, 132, 133, 134, 135, 136, 137, 138, 139, 140, 141, 142, 143, 144, 145, 146, 147, 148, 149, 150, 151, 152, 153, 154, 155, 156, 157, 158, 159, 160, 161, 162, 163, 164, 165, 166, 167, 169, 170, 171, 172, 173, 174, 175, 176, 177, 178, 179, 180, 181, 182, 183, 184, 185, 186, 187, 188, 189, 190, 191, 192, 193, 194, 195, 196, 197, 198, 199

and

PIPELINE LICENCES (PLs) 2, 5, 9 and 15

1. Notation of receipt of Bank Guarantee dated 27 October 2005, is hereby entered on the commercial register.
2. Security is held to cover any event occurring in any licence operated by Santos Limited on behalf of the respective Cooper Basin Joint Ventures in South Australia.
3. Cash security held in respect of PPL 152 is hereby discharged to Santos Limited.
4. Bank Guarantees held in respect of the above referenced PLs and PPLs (excluding PPL 152) are hereby discharged to Santos Limited.



BARRY A GOLDSTEIN
Director Petroleum
Minerals and Energy Division
Primary Industries and Resources SA
Delegate of the Minister for Mineral Resources
Development

Date: 23 November 2005

Petroleum Act 2000

S.115

MEMORANDUM

PETROLEUM PRODUCTION LICENCES 6, 7, 8, 9, 10, 11, 12, 13, 14, 15, 16, 17, 18, 19, 20, 22, 23, 24, 25, 26, 27, 28, 29, 30, 31, 32, 33, 34, 35, 36, 37, 38, 39, 40, 41, 42, 43, 44, 45, 46, 47, 48, 49, 50, 51, 52, 53, 54, 55, 56, 57, 58, 59, 60, 61, 63, 64, 65, 66, 67, 68, 69, 70, 71, 72, 73, 74, 75, 76, 77, 78, 79, 80, 81, 82, 83, 84, 85, 86, 87, 88, 89, 90, 91, 92, 93, 94, 95, 96, 97, 98, 99, 100, 101, 102, 103, 104, 105, 106, 107, 108, 109, 110, 111, 113, 114, 115, 116, 117, 118, 119, 120, 121, 122, 123, 124, 125, 126, 127, 128, 129, 130, 131, 132, 133, 134, 135, 136, 137, 138, 139, 140, 141, 142, 143, 144, 145, 146, 147, 148, 149, 150, 151, 152, 153, 154, 155, 156, 157, 158, 159, 160, 161, 162, 163, 164, 165, 166, 167, 169, 170, 171, 172, 173, 174, 175, 176, 177, 178, 179, 180, 181, 182, 183, 184, 185, 186, 187, 188, 189, 190, 191, 192, 193, 194, 195, 196, 197, 198, 199

PIPELINE LICENCES 2, 5, 9 AND 15

1. Notation of registrable dealing as evidenced by the following document is hereby entered on the Public Register;

- SA 2004-44 DPPL Security dated 21 May 2004 between Delhi Petroleum Pty Ltd and Westpac Banking Corporation.



Paul Holloway

Leader of the Government in the Legislative Council
Minister for Industry, Trade and Regional Development
Minister for Mineral Resources Development
Minister for Small Business

Date: 23/7/04

Petroleum Act 2000

S.115(2)(e)

S.117(2)(b)

MEMORANDUM

PETROLEUM PRODUCTION LICENCES (PPLs) 6, 7, 8, 9, 10, 11, 12, 13, 14, 15, 16, 17, 18, 19, 20, 22, 23, 24, 25, 26, 27, 28, 29, 30, 31, 32, 33, 34, 35, 36, 37, 38, 39, 40, 41, 42, 43, 44, 45, 46, 47, 48, 49, 50, 51, 52, 53, 54, 55, 56, 57, 58, 59, 60, 61, 63, 64, 65, 66, 67, 68, 69, 70, 71, 72, 73, 74, 75, 76, 77, 78, 79, 80, 81, 82, 83, 84, 85, 86, 87, 88, 89, 90, 91, 92, 93, 94, 95, 96, 97, 98, 99, 100, 101, 102, 103, 104, 105, 106, 107, 108, 109, 110, 111, 112, 113, 114, 115, 116, 117, 118, 119, 120, 121, 122, 123, 124, 125, 126, 127, 128, 129, 130, 131, 132, 133, 134, 135, 136, 137, 138, 139, 140, 141, 142, 143, 144, 145, 146, 147, 148, 149, 150, 151, 152, 153, 154, 155, 156, 157, 158, 159, 160, 161, 162, 163, 164, 165, 166, 167, 169, 170, 171, 172, 173, 174, 175, 176, 177, 178, 179, 180, 181, 182, 183, 184, 185, 186, 187, 188, 189, 190, 191, 192, 193, 194, 195, 196, 197, 198 and 199

- 1 Pursuant to sections 115(2)(e) and 117(2)(b) of the *Petroleum Act 2000*, notation is hereby entered on the public and commercial register for each of the abovementioned PPLs, that the register created under the then *Petroleum Act 1940*, relative to Petroleum Exploration Licences 5 and 6, which expired on 27 February 1999, is adopted as part of the commercial register for each of the above said PPLs

Dated: 7 May 2004



T. AUST
A/Director Petroleum
Minerals and Energy Division
Primary Industries and Resources SA
Delegate of the Minister for Mineral
Resources Development

**Petroleum Act 2000
S.115**

MEMORANDUM

PETROLEUM PRODUCTION LICENCES

PPL's 6, 7, 8, 9, 10, 11, 12, 13, 14, 15, 16, 17, 18, 19, 20, 22, 23, 24, 25, 27, 28, 29, 30, 31, 32, 33, 34, 35, 36, 37, 38, 39, 40, 41, 42, 43, 44, 45, 46, 47, 48, 49, 50, 51, 52, 53, 54, 55, 56, 57, 58, 59, 60, 61, 63, 64, 65, 66, 67, 68, 69, 70, 71, 72, 73, 74, 75, 78, 79, 80, 81, 82, 83, 84, 85, 86, 87, 88, 89, 90, 91, 92, 93, 94, 95, 96, 97, 98, 99, 100, 101, 102, 103, 104, 105, 106, 107, 108, 109, 110, 111, 112, 113, 114, 115, 116, 117, 119, 120, 124, 126, 127, 128, 129, 130, 132, 133, 134, 135, 137, 138, 139, 140, 141, 143, 144, 145, 146, 148, 149, 150, 151, 153, 154, 155, 157, 159, 160, 161, 162, 163, 164, 165, 166, 169, 170, 171, 172, 173, 174, 175, 176, 177, 178, 179, 180, 181, 183, 184, 185, 186, 188, 189, 190, 192, 193, 195, 196, 198, 199;

And

**PIPELINE LICENCE
PL 2**

1. Notation of change of company name –

From: Basin Oil NL
To: Basin Oil Pty Ltd

is hereby entered on the public register of licences.

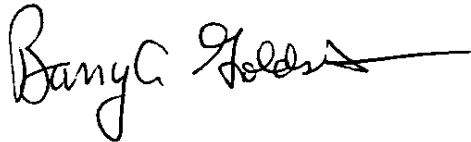

BARRY A GOLDSTEIN
Director Petroleum
Office of Minerals and Energy Resources
Delegate of the Minister for Mineral Resources
Development

Date: 15 October 2002

Form **242**

FREEHILL HOLLINGDALE & PAGE
AMP BUILDING
22nd Fl
140 ST Georges Terrace
PERTH WA 6000

Remove this top section if desired before framing

Certificate of Registration on Change of Type and Conversion to a Proprietary Company

This is to certify that

BASIN OIL N.L.

Australian Company Number 000 628 017

on the eighth day of June 2000 converted to
a company limited by shares
and on the eighth day of June 2000 changed
to a proprietary company.

The name of the company is now

BASIN OIL PTY LTD

Australian Company Number 000 628 017

The company is taken to be registered as a company
under the Corporations Law of New South Wales.

Issued by the
Australian Securities and Investments Commission
on this eighth day of June, 2000.



Alan Cameron
Chairman



CERTIFICATE

PETROLEUM ACT 2000

Grant of Production Licences

Office of Minerals and Energy Resources 15 May 2001.

NOTICE is hereby given that pursuant to delegated powers dated 25 September 2000, *Gazette* 28 September 2000, page 2289, the undermentioned Production Licence has been granted under the provisions of the Petroleum Act 2000.

R. A. LAWS, Director, Petroleum Group, Delegate of the Minister for Minerals and Energy

Licence Numbers	Licencees	Locality	Date Effective From
171, 172, 175, 181, 183, 185, 186, 188 to 190, 192, 196 and 198	Santos Ltd Delhi Petroleum Pty Ltd Origin Energy Resources Ltd Vamgas Pty Ltd Novus (Aust) Resources NL Alliance Petroleum Australia Pty Ltd Reef Oil Pty Ltd Santos Petroleum Pty Ltd Bridge Oil Developments Pty Ltd Santos (BOL) Pty Ltd Basin Oil NL	Various Fields in the Cooper Basin of South Australia	15.5.2001

PL 171:

Description of the Area

All that part of the State of South Australia bounded as follows: Commencing at a point being the intersection of latitude 28°12'50"S AGD66 and longitude 139°58'40"E AGD66, thence west to longitude 139°57'50"E AGD66, south to latitude 28°14'00"S AGD66, east to longitude 139°58'00"E AGD66, north to latitude 28°13'50"S AGD66, east to longitude 139°58'10"E AGD66, north to latitude 28°13'30"S AGD66, east to longitude 139°58'20"E AGD66, north to latitude 28°13'20"S AGD66, east to longitude 139°58'30"E AGD66, north to latitude 28°13'00"S AGD66, east to longitude 139°58'40"E AGD66, north to latitude 28°12'30"S AGD66, east to longitude 139°59'00"E AGD66, north to latitude 28°12'00"S AGD66, east to longitude 140°00'00"E Clarke 1858, south to latitude 28°12'40"S AGD66, east to longitude 140°00'30"E AGD66, south to latitude 28°13'40"S AGD66, east to longitude 140°00'50"E AGD66, south to latitude 28°14'50"S AGD66, west to longitude 140°00'30"E AGD66, south to latitude 28°15'00"S AGD66, west to longitude 140°00'10"E AGD66, south to latitude 28°15'10"S AGD66, west to longitude 140°00'00"E Clarke 1858, south to latitude 28°15'20"S AGD66, west to longitude 139°59'30"E AGD66, south to latitude 28°15'40"S AGD66, west to longitude 139°59'10"E AGD66, south to latitude 28°15'50"S AGD66, west to longitude 139°58'50"E AGD66, south to latitude 28°16'00"S AGD66, west to longitude 139°58'30"E AGD66, south to latitude 28°16'10"S AGD66, west to longitude 139°58'00"E AGD66, south to latitude 28°16'30"S AGD66, west to longitude 139°57'10"E AGD66, north to latitude 28°13'20"S AGD66, east to longitude 139°57'20"E AGD66, north to latitude 28°15'00"S AGD66, east to longitude 139°58'30"E AGD66, north to latitude 28°14'40"S AGD66, east to longitude 139°58'50"E AGD66, north to latitude 28°14'20"S AGD66, east to longitude 139°59'00"E AGD66, north to latitude 28°14'00"S AGD66, east to longitude 139°59'10"E AGD66, north to latitude 28°13'50"S AGD66, east to longitude 139°59'20"E AGD66, north to latitude 28°12'50"S AGD66 and west to the point of commencement.

Area: 23.56 km² approximately

PL 172:

Description of the Area

All that part of the State of South Australia bounded as follows: Commencing at a point being the intersection of latitude 28°19'40"S AGD66 and longitude 140°08'40"E AGD66, thence east to longitude 140°10'20"E AGD66, south to latitude 28°20'00"S AGD66, east to longitude 140°10'30"E AGD66, south to latitude 28°20'10"S AGD66, east to longitude 140°11'50"E AGD66, south to latitude 28°21'30"S AGD66, east to longitude 140°12'40"E AGD66, south to latitude 28°21'50"S AGD66, east to longitude 140°13'30"E AGD66, south to latitude 28°22'10"S AGD66, east to longitude 140°14'20"E AGD66, south to latitude 28°22'30"S AGD66, east to longitude 140°15'10"E AGD66, south to latitude 28°22'50"S AGD66, east to longitude 140°17'10"E AGD66, south to latitude 28°23'00"S AGD66, east to longitude 140°17'30"E AGD66, north to latitude 28°22'50"S AGD66, east to longitude 140°18'20"E AGD66, south to latitude 28°23'10"S AGD66, west to longitude 140°16'30"E AGD66, south to latitude 28°23'40"S AGD66, east to longitude 140°17'50"E AGD66, south to latitude 28°24'00"S AGD66, east to longitude 140°18'20"E AGD66, south to latitude 28°24'20"S AGD66, east to longitude 140°18'50"E AGD66, south to latitude 28°24'40"S AGD66, east to longitude 140°19'10"E AGD66, south to latitude 28°25'00"S AGD66, east to longitude 140°19'30"E AGD66, south to latitude 28°25'20"S AGD66, west to longitude 140°18'50"E AGD66, south to longitude 140°19'10"E AGD66, south to latitude 28°25'50"S AGD66, west to longitude 140°18'50"E AGD66, south to latitude 28°26'20"S AGD66, west to longitude 140°18'30"E AGD66, south to latitude 28°26'50"S AGD66, west to longitude 140°17'10"E AGD66, north to latitude 28°26'40"S AGD66, west to longitude 140°16'40"E AGD66, north to latitude 28°26'30"S AGD66, west to longitude 140°16'10"E AGD66, north to latitude 28°26'20"S AGD66, west to longitude 140°15'40"E AGD66, north to latitude 28°26'10"S AGD66, west to longitude 140°15'10"E AGD66, north to latitude 28°26'00"S AGD66, west to longitude 140°14'40"E AGD66, north to latitude 28°25'40"S AGD66, west to longitude 140°14'10"E AGD66, north to latitude 28°25'30"S AGD66, west to longitude 140°13'40"E AGD66, north to latitude 28°25'20"S AGD66, west to longitude 140°13'10"E AGD66, north to latitude 28°25'10"S AGD66, west to longitude 140°12'40"E AGD66, north to latitude 28°25'00"S Clarke 1858, west to longitude 140°12'00"E AGD66, north to latitude 28°24'40"S AGD66, west to longitude 140°11'30"E AGD66, north to latitude 28°24'30"S AGD66, west to longitude 140°11'00"E AGD66, north to latitude 28°24'20"S AGD66, west to longitude 140°10'30"E AGD66, north to latitude 28°24'10"S AGD66, west to longitude 140°10'00"E AGD66, north to latitude 28°23'50"S AGD66, west to longitude 140°09'30"E AGD66, north to latitude 28°23'40"S AGD66, west to longitude 140°08'50"E AGD66, north to latitude 28°23'30"S AGD66, west to longitude 140°08'20"E AGD66, north to latitude 28°23'20"S AGD66, west to longitude 140°07'50"E AGD66, north to latitude 28°23'10"S AGD66, west to longitude 140°07'20"E AGD66, north to latitude 28°22'50"S AGD66, west to longitude 140°06'50"E AGD66, north to latitude 28°22'40"S AGD66, west to longitude 140°06'20"E AGD66, north to latitude 28°22'30"S AGD66, west to longitude 140°05'50"E AGD66, north to latitude 28°21'50"S AGD66, west to longitude 140°04'00"E Clarke 1858, north to latitude 28°21'00"S AGD66, east to longitude 140°04'50"E AGD66, north to latitude 28°20'50"S AGD66, east to longitude 140°05'50"E AGD66, south to latitude 28°21'50"S AGD66, east to longitude 140°06'00"E AGD66, south to latitude 28°22'00"S AGD66, east to longitude 140°06'10"E AGD66, south to latitude 28°22'10"S AGD66, east to longitude 140°07'20"E AGD66, north to latitude 28°20'40"S AGD66, east to longitude 140°08'30"E AGD66, north to latitude 28°20'20"S AGD66, east to longitude 140°08'40"E AGD66 and north to the point of commencement.

Area: 126.8 km² approximately

PL 175:

Description of the Area

All that part of the State of South Australia, bounded as follows: Commencing at a point being the intersection of latitude 28°13'40"S AGD66 and longitude 139°51'40"E AGD66, thence east to longitude 139°52'10"E AGD66, north to latitude 28°13'30"S AGD66, east to longitude 139°52'50"E AGD66, north to latitude 28°13'20"S AGD66, east to longitude 139°53'10"E AGD66, north to latitude 28°13'10"S AGD66, east to longitude 139°53'30"E AGD66, north to latitude 28°13'00"S AGD66, east to longitude 139°53'50"E AGD66, north to latitude 28°12'50"S AGD66, east to longitude 139°54'00"E AGD66, north to latitude 28°12'30"S AGD66, east to longitude 139°54'20"E AGD66, north to latitude 28°12'10"S AGD66, east to longitude 139°54'30"E AGD66, south to latitude 28°12'20"S AGD66, east to longitude 139°55'10"E AGD66, north to latitude 28°12'10"S AGD66, east to longitude 139°55'20"E AGD66, north to latitude 28°12'00"S AGD66, east to longitude 139°55'30"E AGD66, north to latitude 28°11'50"S AGD66, east to longitude 139°56'00"E AGD66, south to latitude 28°12'10"S AGD66, west to longitude 139°55'40"E AGD66, south to latitude 28°12'20"S AGD66, west to longitude 139°55'30"E AGD66, south to latitude 28°12'30"S AGD66, west to longitude 139°55'20"E AGD66, south to latitude 28°12'40"S AGD66, west to longitude 139°54'40"E AGD66, south to latitude 28°13'10"S AGD66, east to longitude 139°54'50"E AGD66, south to latitude 28°13'30"S AGD66, east to longitude 139°55'00"E AGD66, south to latitude 28°13'40"S AGD66, east to longitude 139°55'10"E AGD66, south to latitude 28°13'50"S AGD66, east to longitude 139°57'00"E AGD66, south to latitude 28°13'30"S AGD66, west to longitude 139°56'50"E AGD66, north to latitude 28°13'10"S AGD66, west to longitude 139°56'40"E AGD66, north to latitude 28°13'00"S AGD66, west to longitude 139°56'20"E AGD66, north to latitude 28°12'50"S AGD66, east to longitude 139°57'10"E AGD66, north to latitude 28°12'35"S AGD66, east to longitude 139°57'40"E AGD66, south to latitude 28°12'50"S AGD66, east to longitude 139°57'50"E AGD66, south to latitude 28°14'00"S AGD66, west to longitude 139°57'40"E AGD66, south to latitude 28°14'20"S AGD66, west to longitude 139°57'30"E AGD66, south to latitude 28°15'00"S AGD66, west to longitude 139°57'20"E AGD66, south to latitude 28°15'20"S AGD66, west to longitude 139°56'40"E AGD66, south to latitude 28°15'30"S AGD66, west to longitude 139°56'20"E AGD66, south to latitude 28°15'40"S AGD66, west to longitude 139°56'10"E AGD66, south to latitude 28°15'50"S AGD66, west to longitude 139°55'10"E AGD66, south to latitude 28°16'00"S AGD66, west to longitude 139°54'50"E AGD66, south to latitude 28°16'20"S AGD66, west to longitude 139°54'40"E AGD66, south to latitude 28°16'30"S AGD66, west to longitude 139°53'30"E AGD66, south to latitude 28°16'40"S AGD66, west to longitude 139°52'00"E AGD66, north to latitude 28°16'00"S AGD66, west to longitude 139°51'40"E AGD66 and north to the point of commencement but excluding the area bounded as follows: Commencing at a point being the intersection of latitude 28°13'20"S AGD66 and longitude 139°53'30"E AGD66, thence east to longitude 139°54'10"E AGD66, south to latitude 28°13'40"S AGD66, east to longitude 139°54'30"E AGD66, south to latitude 28°14'20"S AGD66, east to longitude 139°54'40"E AGD66, south to latitude 28°14'30"S AGD66, east to longitude 139°55'00"E AGD66, south to latitude 28°15'20"S AGD66, west to longitude 139°53'40"E AGD66, north to latitude 28°14'20"S AGD66, west to longitude 139°53'30"E AGD66 and north to the point of commencement.

Area: 45.92 km² approximately

PL 181:

Description of the Area

All that part of the State of South Australia, bounded as follows: Commencing at a point being the intersection of latitude 28°16'00"S AGD66 and longitude 140°04'10"E AGD66, thence east to longitude 140°05'20"E AGD66, south to latitude 28°16'10"S AGD66, east to longitude 140°06'10"E AGD66, south to latitude 28°16'20"S AGD66, east to longitude 140°07'10"E AGD66, south to latitude 28°16'30"S AGD66, east to longitude 140°08'10"E AGD66, south to latitude 28°16'40"S AGD66, east to longitude 140°09'20"E AGD66, south to latitude 28°16'50"S AGD66, west to longitude 140°09'10"E AGD66, south to latitude 28°17'00"S AGD66, west to longitude 140°08'40"E AGD66, south to latitude 28°17'10"S AGD66, west to longitude 140°08'20"E AGD66, south to latitude 28°17'20"S AGD66, west to longitude 140°08'00"E AGD66, south to latitude 28°17'30"S AGD66, west to longitude 140°07'30"E AGD66, south to latitude 28°17'40"S AGD66, west to longitude 140°07'00"E AGD66, south to latitude 28°17'50"S AGD66, west to longitude 140°06'30"E AGD66, south to latitude 28°18'00"S AGD66, west to longitude 140°05'30"E AGD66, south to latitude 28°18'10"S AGD66, west to longitude 140°05'10"E AGD66, north to latitude 28°18'00"S AGD66, west to longitude 140°05'00"E AGD66, north to latitude 28°17'40"S AGD66, west to longitude 140°04'50"E AGD66, north to latitude 28°17'20"S AGD66, west to longitude 140°04'40"E AGD66, north to latitude 28°17'00"S AGD66, west to longitude 140°04'30"E AGD66, north to latitude 28°16'40"S AGD66, west to longitude 140°04'20"E AGD66, north to latitude 28°16'20"S AGD66, west to longitude 140°04'10"E AGD66 and north to the point of commencement.

Area: 18.44 km² approximately

PL 183

Description of the Area

All that part of the State of South Australia, bounded as follows: Commencing at a point being the intersection of latitude 27°46'50"S AGD66 and longitude 139°56'50"E AGD66, thence east to longitude 139°57'20"E AGD66, south to latitude 27°47'40"S AGD66, west to longitude 139°57'10"E AGD66, south to latitude 27°48'30"S AGD66, east to longitude 139°58'20"E AGD66, south to latitude 27°48'50"S AGD66, east to longitude 139°58'30"E AGD66, south to latitude 27°49'00"S AGD66, east to longitude 139°58'40"E AGD66, south to latitude 27°49'20"S AGD66, east to longitude 139°59'00"E AGD66, south to latitude 27°50'20"S AGD66, west to longitude 139°56'50"E AGD66, north to latitude 27°48'30"S AGD66, west to longitude 139°56'10"E AGD66, north to latitude 27°47'30"S AGD66, east to longitude 139°56'30"E AGD66, north to latitude 27°47'10"S AGD66, east to longitude 139°56'50"E AGD66 and north to the point of commencement.

Area: 15.24 km² approximately

PL 185:

Description of the Area

All that part of the State of South Australia, bounded as follows: Commencing at a point being the intersection of latitude 28°06'00"S Clarke 1858 and longitude 139°58'10"E AGD66, thence east to longitude 140°02'00"E Clarke 1858, south to latitude 28°07'00"S Clarke 1858, east to longitude 140°04'00"E Clarke 1858, south to latitude 28°08'30"S AGD66, west to longitude 140°02'30"E AGD66, north to latitude 28°07'30"S AGD66, west to longitude 140°01'10"E AGD66, south to latitude 28°07'40"S AGD66, west to longitude 140°01'00"E AGD66, south to latitude 28°07'50"S AGD66, west to longitude 140°00'30"E AGD66, south to latitude 28°08'30"S AGD66, east to longitude 140°01'00"E AGD66, south to latitude 28°08'50"S AGD66, east to longitude 140°01'10"E AGD66, south to latitude 28°09'00"S AGD66, west to longitude 140°01'00"E AGD66, south to latitude 28°09'30"S AGD66, west to longitude 140°00'30"E AGD66, north to latitude 28°09'30"S AGD66, west to longitude 140°00'10"E AGD66, north to latitude 28°09'10"S AGD66, west to longitude 139°59'50"E AGD66, north to latitude 28°08'20"S AGD66, west to longitude 139°58'45"E AGD66, north to latitude 28°08'00"S AGD66, west to longitude 139°58'30"E AGD66, north to latitude 28°07'00"S AGD66, west to longitude 139°58'10"E AGD66 and north to the point of commencement.

Area: 33.65 km² approximately

PL 186:

Description of the Area

All that part of the State of South Australia, bounded as follows: Commencing at a point being the intersection of latitude 28°39'00"S AGD66 and longitude 140°15'40"E AGD66, thence east to longitude 140°16'40"E AGD66, south to latitude 28°39'10"S AGD66, east to longitude 140°18'20"E AGD66, south to latitude 28°40'00"S AGD66, west to longitude 140°17'50"E AGD66, south to latitude 28°40'50"S AGD66, west to longitude 140°17'40"E AGD66, south to latitude 28°41'30"S AGD66, west to longitude 140°17'10"E AGD66, south to latitude 28°42'10"S AGD66, west to longitude 140°16'10"E AGD66, north to latitude 28°41'30"S AGD66, west to longitude 140°15'40"E AGD66, south to latitude 28°41'50"S AGD66, west to longitude 140°15'00"E Clarke 1858, north to latitude 28°40'40"S AGD66, east to longitude 140°15'30"E AGD66, north to latitude 28°40'30"S AGD66, east to longitude 140°15'40"E AGD66, and north to the point of commencement.

Area: 21.45 km² approximately.

PL 188:

Description of the Area

All that part of the State of South Australia, bounded as follows: Commencing at a point being the intersection of latitude 28°27'00"S AGD66 and longitude 140°27'20"E AGD66, thence east to longitude 140°28'20"E AGD66, south to latitude 28°27'20"S AGD66, east to longitude 140°28'40"E AGD66, south to latitude 28°27'25"S AGD66, east to longitude 140°28'50"E AGD66, south to latitude 28°27'40"S AGD66, west to longitude 140°28'40"E AGD66, south to latitude 28°27'50"S AGD66, west to longitude 140°28'30"E AGD66, south to latitude 28°28'00"S AGD66, west to longitude 140°28'20"E AGD66, south to latitude 28°28'30"S AGD66, east to longitude 140°28'30"E AGD66, south to latitude 28°28'40"S AGD66, east to longitude 140°28'40"E AGD66, south to latitude 28°29'10"S AGD66, east to longitude 140°29'10"E AGD66, north to latitude 28°29'00"S AGD66, east to longitude 140°29'30"E AGD66, north to latitude 28°28'50"S AGD66, east to longitude 140°29'40"E AGD66, north to latitude 28°28'20"S AGD66, east to longitude 140°30'20"E AGD66, north to latitude 28°27'10"S AGD66, east to longitude 140°31'05"E AGD66, south to latitude 28°28'00"S Clarke 1858, west to longitude 140°31'00"E Clarke 1858, south to latitude 28°28'40"S AGD66, west to longitude 140°29'55"E AGD66, south to latitude 28°29'00"S Clarke 1858, west to longitude 140°30'00"E Clarke 1858, south to latitude 28°29'15"S AGD66, west to longitude 140°29'10"E AGD66, south to latitude 28°29'30"S AGD66, west to longitude 140°28'15"E AGD66, north to latitude 28°28'55"S AGD66, west to longitude 140°27'40"E AGD66, south to latitude 28°29'10"S AGD66, west to longitude 140°27'10"E AGD66, north to latitude 28°29'05"S AGD66, west to longitude 140°26'35"E AGD66, north to latitude 28°28'00"S AGD66, east to longitude 140°26'50"E AGD66, north to latitude 28°27'30"S AGD66, east to longitude 140°27'20"E AGD66 and north to the point of commencement.

Area: 16.03 km² approximately

PL 189:

Description of the Area

All that part of the State of South Australia, bounded as follows: Commencing at a point being the intersection of latitude 28°14'20"S AGD66 and longitude 140°28'00"E Clarke 1858, thence east to longitude 140°32'00"E AGD66, south to latitude 28°14'40"S AGD66, east to longitude 140°32'10"E AGD66, south to latitude 28°15'00"S AGD66, east to longitude 140°32'30"E AGD66, south to latitude 28°15'20"S AGD66, east to longitude 140°32'50"E AGD66, south to latitude 28°15'40"S AGD66, east to longitude 140°33'00"E AGD66, south to latitude 28°16'00"S AGD66, west to longitude 140°32'30"E AGD66, south to latitude 28°16'30"S AGD66, west to longitude 140°32'10"E AGD66, south to latitude 28°16'40"S AGD66, west to longitude 140°31'50"E AGD66, south to latitude 28°16'50"S AGD66, west to longitude 140°31'20"E AGD66, south to latitude 28°17'00"S AGD66, west to longitude 140°31'00"E AGD66, south to latitude 28°17'10"S AGD66, west to longitude 140°30'50"E AGD66, south to latitude 28°17'20"S AGD66, west to longitude 140°30'30"E AGD66, south to latitude 28°17'30"S AGD66, west to longitude 140°30'10"E AGD66, south to latitude 28°17'40"S AGD66, west to longitude 140°30'00"E AGD66, south to latitude 28°17'50"S AGD66, west to longitude 140°29'40"E AGD66, south to latitude 28°18'00"S AGD66, west to longitude 140°29'10"E AGD66, south to latitude 28°18'10"S AGD66, west to longitude 140°28'50"E AGD66, south to latitude 28°18'20"S AGD66, west to longitude 140°28'20"E AGD66, south to latitude 28°18'30"S AGD66, west to longitude 140°27'50"E AGD66, south to latitude 28°18'50"S AGD66, west to longitude 140°27'30"E AGD66, south to latitude 28°19'10"S AGD66, west to longitude 140°27'10"E AGD66, south to latitude 28°19'30"S AGD66, west to longitude 140°26'50"E AGD66, south to latitude 28°19'50"S AGD66, west to longitude 140°26'40"E AGD66, south to latitude 28°20'10"S AGD66, west to longitude 140°26'20"E AGD66, south to latitude 28°20'30"S AGD66, west to longitude 140°26'00"E AGD66, south to latitude 28°20'50"S AGD66, west to longitude 140°25'30"E AGD66, south to latitude 28°21'10"S AGD66, west to longitude 140°25'00"E AGD66, south to latitude 28°21'30"S AGD66, west to longitude 140°24'30"E AGD66, south to latitude 28°21'50"S AGD66, west to longitude 140°24'10"E AGD66, south to latitude 28°22'10"S AGD66, west to longitude 140°23'50"E AGD66, south to latitude 28°22'30"S AGD66, west to longitude 140°23'10"E AGD66, south to latitude 28°22'50"S AGD66, west to longitude 140°22'30"E AGD66, south to latitude 28°23'10"S AGD66, west to longitude 140°22'00"E AGD66, south to latitude 28°23'30"S AGD66, west to longitude 140°21'30"E AGD66, south to latitude 28°23'50"S AGD66, west to longitude 140°21'00"E AGD66, south to latitude 28°24'10"S AGD66, west to longitude 140°20'30"E AGD66, south to latitude 28°24'30"S AGD66, west to longitude 140°20'00"E AGD66, south to latitude 28°24'50"S AGD66, west to longitude 140°19'40"E AGD66, south to latitude 28°25'00"S AGD66, west to longitude 140°19'10"E AGD66, north to latitude 28°24'40"S AGD66, west to longitude 140°18'50"E AGD66, north to latitude 28°24'20"S AGD66, west to longitude 140°18'20"E AGD66, north to latitude 28°24'00"S AGD66, west to longitude 140°17'50"E AGD66, north to latitude 28°23'40"S AGD66, west to longitude 140°16'30"E AGD66, north to latitude 28°23'10"S AGD66, east to longitude 140°18'20"E AGD66, north to latitude 28°22'50"S AGD66, west to longitude 140°17'30"E AGD66, north to latitude 28°21'00"S AGD66, east to longitude 140°18'00"E AGD66, north to latitude 28°18'00"S Clarke 1858, east to longitude 140°19'00"E Clarke 1858, north to latitude 28°16'00"S Clarke 1858, east to longitude 140°21'00"E Clarke 1858, north to latitude 28°15'00"S Clarke 1858, east to longitude 140°28'00"E Clarke 1858 and north to the point of commencement.

Area: 259.73 km² approximately

PL 190:

Description of the Area

All that part of the State of South Australia, bounded as follows: Commencing at a point being the intersection of latitude 28°09'00"S AGD66 and longitude 140°01'00"E AGD66, thence east to longitude 140°02'20"E AGD66, north to latitude 28°08'50"S AGD66, east to longitude 140°02'30"E AGD66, north to latitude 28°08'30"S AGD66, east to longitude 140°04'00"E Clarke 1858, south to latitude 28°10'00"S Clarke 1858, east to longitude 140°06'00"E Clarke 1858, south to latitude 28°11'00"S Clarke 1858, east to longitude 140°07'00"E Clarke 1858, south to latitude 28°12'00"S Clarke 1858, east to longitude 140°08'00"E Clarke 1858, south to latitude 28°14'00"S Clarke 1858, east to longitude 140°09'00"E Clarke 1858, south to latitude 28°15'00"S Clarke 1858, east to longitude 140°10'00"E Clarke 1858, south to latitude 28°16'00"S Clarke 1858, east to longitude 140°11'00"E Clarke 1858, south to latitude 28°19'00"S Clarke 1858, east to longitude 140°17'00"E Clarke 1858, north to latitude 28°18'00"S Clarke 1858, east to longitude 140°18'00"E AGD66, south to latitude 28°21'00"S AGD66, west to longitude 140°17'30"E AGD66, south to latitude 28°23'00"S AGD66, west to longitude 140°17'10"E AGD66, north to latitude 28°22'50"S AGD66, west to longitude 140°15'10"E AGD66, north to latitude 28°22'30"S AGD66, west to longitude 140°14'20"E AGD66, north to latitude 28°22'10"S AGD66, west to longitude 140°13'30"E AGD66, north to latitude 28°21'50"S AGD66, west to longitude 140°12'40"E AGD66, north to latitude 28°21'30"S AGD66, west to longitude 140°11'50"E AGD66, north to latitude 28°21'10"S AGD66, west to longitude 140°10'50"E AGD66, north to latitude 28°20'10"S AGD66, west to longitude 140°10'30"E AGD66, north to latitude 28°20'00"S AGD66, west to longitude 140°10'20"E AGD66, north to latitude 28°19'40"S AGD66, west to longitude 140°08'40"E AGD66, south to latitude 28°20'20"S AGD66, west to longitude 140°08'30"E AGD66, south to latitude 28°20'40"S AGD66, west to longitude 140°06'10"E AGD66, south to latitude 28°20'50"S AGD66, west to longitude 140°04'50"E AGD66, south to latitude 28°21'00"S AGD66, west to longitude 140°04'00"E Clarke 1858, north to latitude 28°19'10"S AGD66, east to longitude 140°04'10"E AGD66, north to latitude 28°18'50"S AGD66, east to longitude 140°04'30"E AGD66, north to latitude 28°18'30"S AGD66, east to longitude 140°04'50"E AGD66, north to latitude 28°18'20"S AGD66, east to longitude 140°05'10"E AGD66, north to latitude 28°18'10"S AGD66, east to longitude 140°05'30"E AGD66, north to latitude 28°18'00"S AGD66, east to longitude 140°06'30"E AGD66, north to latitude 28°17'50"S AGD66, east to longitude 140°07'00"E AGD66, north to latitude 28°17'40"S AGD66, east to longitude 140°07'30"E AGD66, north to latitude 28°17'30"S AGD66, east to longitude 140°08'00"E AGD66, north to latitude 28°17'20"S AGD66, east to longitude 140°08'20"E AGD66, north to latitude 28°17'10"S AGD66, east to longitude 140°08'40"E AGD66, north to latitude 28°17'00"S AGD66, east to longitude 140°09'10"E AGD66, north to latitude 28°16'50"S AGD66, east to longitude 140°09'20"E AGD66, north to latitude 28°16'40"S AGD66, west to longitude 140°08'10"E AGD66, north to latitude 28°16'30"S AGD66, west to longitude 140°07'10"E AGD66, north to latitude 28°16'20"S AGD66, west to longitude 140°06'00"E AGD66, north to latitude 28°16'10"S AGD66, west to longitude 140°05'20"E AGD66, north to latitude 28°16'00"S AGD66, west to longitude 140°04'10"E AGD66, north to latitude 28°15'40"S AGD66, west to longitude 140°04'00"E AGD66, north to latitude 28°15'30"S AGD66, east to longitude 140°04'40"E AGD66, north to latitude 28°15'10"S AGD66, east to longitude 140°05'00"E AGD66, north to latitude 28°15'00"S AGD66, east to longitude 140°05'20"E AGD66, north to latitude 28°14'30"S AGD66, west to longitude 140°04'30"E AGD66, north to latitude 28°13'40"S AGD66, west to longitude 140°04'10"E AGD66, north to latitude 28°13'30"S AGD66, west to longitude 140°03'40"E AGD66, west to longitude 140°03'20"E AGD66, north to latitude 28°13'20"S AGD66, west to longitude 140°03'30"E AGD66, north to latitude 28°12'50"S AGD66, west to longitude 140°03'20"E AGD66, north to latitude 28°12'40"S AGD66, west to longitude 140°03'00"E AGD66, north to latitude 28°12'30"S AGD66, west to longitude 140°02'40"E AGD66, north to latitude 28°12'20"S AGD66, west to longitude 140°02'10"E AGD66, south to latitude 28°12'40"S AGD66, west to longitude 140°01'30"E AGD66, north to latitude 28°12'30"S AGD66, west to longitude 140°01'20"E AGD66, north to latitude 28°11'50"S AGD66, east to longitude 140°01'30"E AGD66, north to latitude 28°10'50"S AGD66, west to longitude 140°01'20"E AGD66, north to latitude 28°10'30"S AGD66, west to longitude 140°01'00"E AGD66 and north to the point of commencement but excluding the area bounded as follows: Commencing at a point being the intersection of latitude 28°13'10"S AGD66 and longitude 140°06'30"E AGD66, thence east to longitude 140°07'20"E AGD66, south to latitude 28°19'30"S AGD66, west to longitude 140°06'00"E AGD66, north to latitude 28°19'20"S AGD66, west to longitude 140°05'50"E AGD66, north to latitude 28°18'30"S AGD66, east to longitude 140°06'20"E AGD66, north to latitude 28°18'20"S AGD66, east to longitude 140°06'30"E AGD66 and north to the point of commencement.

Area: 231.91 km² approximately

PL 192:

Description of the Area

All that part of the State of South Australia, bounded as follows: Commencing at a point being the intersection of latitude 27°36'20"S AGD66 and longitude 140°22'40"E AGD66, thence east to longitude 140°23'10"E AGD66, south to latitude 27°37'20"S AGD66, west to longitude 140°22'20"E AGD66, south to latitude 27°37'30"S AGD66, west to longitude 140°21'50"E AGD66, south to latitude 27°38'00"S AGD66, west to longitude 140°21'20"E AGD66, south to latitude 27°38'20"S AGD66, west to longitude 140°20'50"E AGD66, south to latitude 27°39'10"S AGD66, west to longitude 140°20'30"E AGD66, south to latitude 27°39'40"S AGD66, west to longitude 140°20'00"E AGD66, south to latitude 27°40'00"S AGD66, west to longitude 140°17'30"E AGD66, north to latitude 27°38'50"S AGD66, east to longitude 140°18'00"E AGD66, south to latitude 27°39'00"S AGD66, east to longitude 140°18'40"E AGD66, north to latitude 27°38'50"S AGD66, east to longitude 140°19'00"E AGD66, north to latitude 27°38'40"S AGD66, east to longitude 140°19'10"E AGD66, north to latitude 27°38'30"S AGD66, east to longitude 140°19'20"E AGD66, north to latitude 27°38'20"S AGD66, east to longitude 140°19'40"E AGD66, north to latitude 27°38'00"S AGD66, east to longitude 140°19'50"E AGD66, north to latitude 27°37'40"S AGD66, east to longitude 140°20'00"E AGD66, north to latitude 27°37'20"S AGD66, east to longitude 140°20'20"E AGD66, north to latitude 27°37'10"S AGD66, east to longitude 140°20'40"E AGD66, north to latitude 27°37'00"S AGD66, east to longitude 140°20'50"E AGD66, north to latitude 27°36'50"S AGD66, east to longitude 140°22'20"E AGD66, north to latitude 27°36'40"S AGD66, east to longitude 140°22'30"E AGD66, north to latitude 27°36'30"S AGD66, east to longitude 140°22'40"E AGD66 and north to the point of commencement.

Area: 23.36 km² approximately

PL 196:

Description of the Area

All that part of the State of South Australia, bounded as follows: Commencing at a point being the intersection of latitude 27°33'10"S AGD66 and longitude 140°10'00"E Clarke 1858, thence east to longitude 140°10'50"E AGD66, south to latitude 27°33'20"S AGD66, east to longitude 140°11'10"E AGD66, south to latitude 27°33'30"S AGD66, east to longitude 140°11'30"E AGD66, south to latitude 27°33'50"S AGD66, east to longitude 140°12'00"E AGD66, south to latitude 27°34'40"S AGD66, east to longitude 140°12'20"E AGD66, south to latitude 27°35'20"S AGD66, east to longitude 140°12'40"E AGD66, south to latitude 27°35'30"S AGD66, east to longitude 140°13'00"E AGD66, south to latitude 27°35'50"S AGD66, east to longitude 140°13'20"E AGD66, south to latitude 27°36'00"S AGD66, east to longitude 140°13'40"E AGD66, south to latitude 27°36'20"S AGD66, east to longitude 140°14'00"E AGD66, south to latitude 27°36'30"S AGD66, east to longitude 140°14'10"E AGD66, south to latitude 27°36'40"S AGD66, east to longitude 140°14'30"E AGD66, south to latitude 27°36'50"S AGD66, east to longitude 140°15'00"E Clarke 1858, south to latitude 27°39'30"S AGD66, east to longitude 140°15'00"E AGD66, south to latitude 27°40'00"S AGD66, west to longitude 140°14'30"E AGD66, west to longitude 140°14'10"E AGD66, south to latitude 27°40'30"S AGD66, west to longitude 140°14'00"E AGD66, south to latitude 27°40'40"S AGD66, west to longitude 140°13'40"E AGD66, south to latitude 27°40'50"S AGD66, west to longitude 140°13'20"E AGD66, south to latitude 27°41'40"S AGD66, east to longitude 140°14'00"E Clarke 1858, south to latitude 27°42'00"S Clarke 1858, west to longitude 140°10'00"E Clarke 1858, north to latitude 27°36'00"S Clarke 1858, west to longitude 140°08'00"E Clarke 1858, north to latitude 27°35'00"S Clarke 1858, east to longitude 140°09'00"E Clarke 1858, north to latitude 27°34'00"S Clarke 1858, east to longitude 140°10'00"E Clarke 1858 and north to the point of commencement.

Area: 110.87 km² approximately

PL 198:

Description of the Area

All that part of the State of South Australia, bounded as follows: Commencing at a point being the intersection of latitude 28°03'00"S AGD66 and longitude 140°43'00"E Clarke 1858, thence east to longitude 140°43'20"E AGD66, south to latitude 28°03'20"S AGD66, east to longitude 140°43'30"E AGD66, south to latitude 28°03'40"S AGD66, east to longitude 140°43'40"E AGD66, south to latitude 28°03'50"S AGD66, east to longitude 140°44'40"E AGD66, north to latitude 28°03'40"S AGD66, east to longitude 140°45'20"E AGD66, north to latitude 28°03'30"S AGD66, east to longitude 140°45'50"E AGD66, north to latitude 28°03'20"S AGD66, east to longitude 140°46'30"E AGD66, north to latitude 28°03'10"S AGD66, east to longitude 140°46'40"E AGD66, north to latitude 28°02'40"S AGD66, east to longitude 140°47'20"E AGD66, north to latitude 28°02'30"S AGD66, east to longitude 140°47'40"E AGD66, north to latitude 28°02'10"S AGD66, east to longitude 140°48'10"E AGD66, north to latitude 28°01'50"S AGD66, east to longitude 140°48'30"E AGD66, north to latitude 28°01'30"S AGD66, east to longitude 140°49'30"E AGD66, south to latitude 28°02'10"S AGD66, west to longitude 140°49'20"E AGD66, south to latitude 28°02'20"S AGD66, west to longitude 140°49'00"E AGD66, south to latitude 28°02'40"S AGD66, west to longitude 140°48'50"E AGD66, south to latitude 28°02'50"S AGD66, west to longitude 140°48'30"E AGD66, south to latitude 28°03'10"S AGD66, west to longitude 140°48'20"E AGD66, south to latitude 28°03'20"S AGD66, west to longitude 140°48'00"E AGD66, south to latitude 28°03'40"S AGD66, west to longitude 140°47'20"E AGD66, south to latitude 28°03'50"S AGD66, west to longitude 140°47'10"E AGD66, south to latitude 28°04'00"S AGD66, west to longitude 140°46'50"E AGD66, south to latitude 28°04'10"S AGD66, west to longitude 140°46'40"E AGD66, south to latitude 28°04'20"S AGD66, west to longitude 140°46'20"E AGD66, south to latitude 28°04'30"S AGD66, west to longitude 140°46'10"E AGD66, south to latitude 28°04'40"S AGD66, west to longitude 140°46'00"E AGD66, west to longitude 140°45'10"E AGD66, north to latitude 28°04'40"S AGD66, west to longitude 140°44'10"E AGD66, north to latitude 28°04'30"S AGD66, west to longitude 140°43'40"E AGD66, south to latitude 28°04'40"S AGD66, west to longitude 140°43'30"E AGD66, south to latitude 28°05'00"S AGD66, west to longitude 140°43'20"E AGD66, south to latitude 28°05'10"S AGD66, west to longitude 140°42'30"E AGD66, north to latitude 28°05'00"S Clarke 1858, east to longitude 140°43'00"E Clarke 1858 and north to the point of commencement.

Area: 24.58 km² approximately

MEMORANDUM

PRODUCTION LICENCE NO. 188

1. This licence granted on *15 May 2001* is hereby entered on the Petroleum Register.
2. A security in the form of a \$15,000 bank guarantee has been lodged with respect to this licence.
3. Interests in the licence are as follows:

	%
• Santos Ltd	40.70
• Delhi Petroleum Pty Ltd	20.21
• Energy Resources Ltd	13.19
• Vamgas Pty Ltd	8.51
• Novus (Aust) Resources NL	4.75
• Bridge Oil Developments Pty Ltd	3.99
• Alliance Petroleum Australia Pty Ltd	3.97
• Basin Oil NL	2.10
• Reef Oil Pty Ltd	1.97
• Santos Petroleum Pty Ltd	0.40
• Santos (BOL) Pty Ltd	0.21



.....
R A LAWS
DIRECTOR PETROLEUM
Delegate of the Minister for Minerals
and Energy

**SOUTH AUSTRALIA
PETROLEUM ACT 2000**

COMMISSIONER OF STATE TAXATION

and

STAMP DUTY
DOCUMENT 1 OF 13
TAXES/2001/01454/5 302109 10-1
DUTY IS NOT CHARGEABLE

COOPER BASIN (RATIFICATION) ACT 1975

PRODUCTION LICENCE NO. 188

I, **ROBERT ANTHONY LAWS**, Director Petroleum, Office of Minerals and Energy Resources, Department of Primary Industries and Resources in the State of South Australia pursuant to the provisions of the *Petroleum Act 2000* and the *Cooper Basin (Ratification) Act 1975* and all other enabling powers for and on behalf of Wayne Anthony Matthew, Minister for Minerals and Energy (Minister) pursuant to delegation dated 25 September 2000 (refer Government Gazette dated 28 September 2000) **HEREBY GRANT JOINTLY TO :-**

- **SANTOS LIMITED**, ABN 80 007 550 923 of Level 29, 91 King William Street, Adelaide, South Australia,
- **DELHI PETROLEUM PTY LTD**, ABN ⁶⁵ 68 007 854 686 of ~~C/- Esso Australia Ltd~~ ✓
12 Riverside Quay, Southbank, Victoria,
- **ORIGIN ENERGY RESOURCES LIMITED**, ABN 66 007 845 338 of Level 12, 1 King William Street, Adelaide, South Australia.
- **VAMGAS PTY LTD**, ABN 76 006 245 110 of Level 29, 91 King William Street, Adelaide, South Australia,
- **NOVUS AUSTRALIA RESOURCES NO LIABILITY**, ABN 75 004 761 255 of Level 9, 321 Kent Street, Sydney, New South Wales,
- **ALLIANCE PETROLEUM AUSTRALIA PTY LTD**, ABN 60 004 559 951 of Level 29, 91 King William Street, Adelaide, SA,
- **REEF OIL PTY LTD**, ABN 70 000 646 800 of Level 29, 91 King William Street, Adelaide, SA,
- **SANTOS PETROLEUM PTY LTD**, ABN 95 000 146 369 of Level 29, 91 King William Street, Adelaide, SA,
- **BRIDGE OIL DEVELOPMENTS PTY LTD**, ABN 30 001 152 049 of Level 29, 91 King William Street, Adelaide, SA,
- **SANTOS (BOL) PTY LTD**, ABN 35 000 670 575 of Level 29, 91 King William Street, Adelaide, SA, 5000
- **BASIN OIL PTY LTD**, ABN 36 000 628 017 of Level 29, St Martins Tower, 44 St Georges Terrace, Perth, WA 6000

(herein after referred to as the 'Licensees') a Production Licence, in relation to all regulated resources except a source of geothermal energy and in respect of the area described below and subject to the conditions set out below, to have effect from the 15th day of May 2001.

DESCRIPTION OF AREA

All that part of the State of South Australia, bounded as follows:-

Commencing at a point being the intersection of latitude 28°27'00"S AGD66 and longitude 140°27'20"E AGD66, thence east to longitude 140°28'20"E AGD66, south to latitude 28°27'20"S AGD66, east to longitude 140°28'40"E AGD66, south to latitude 28°27'25"S AGD66, east to longitude 140°28'50"E AGD66, south to latitude 28°27'40"S AGD66, west to longitude 140°28'40"E AGD66, south to latitude 28°27'50"S AGD66, west to longitude 140°28'30"E AGD66, south to latitude 28°28'00"S AGD66, west to longitude 140°28'20"E AGD66, south to latitude 28°28'30"S AGD66, east to longitude 140°28'30"E AGD66, south to latitude 28°28'40"S AGD66, east to longitude 140°28'40"E AGD66, south to latitude 28°29'10"S AGD66, east to longitude 140°29'10"E AGD66, north to latitude 28°29'00"S AGD66, east to longitude 140°29'30"E AGD66, north to latitude 28°28'50"S AGD66, east to longitude 140°29'40"E AGD66, north to latitude 28°28'20"S AGD66, east to longitude 140°30'20"E AGD66, north to latitude 28°27'10"S AGD66, east to longitude 140°31'05"E AGD66, south to latitude 28°28'00"S Clarke1858, west to longitude 140°31'00"E Clarke1858, south to latitude 28°28'40"S AGD66, west to longitude 140°29'55"E AGD66, south to latitude 28°29'00"S Clarke1858, west to longitude 140°30'00"E Clarke1858, south to latitude 28°29'15"S AGD66, west to longitude 140°29'10"E AGD66, south to latitude 28°29'30"S AGD66, west to longitude 140°28'15"E AGD66, north to latitude 28°28'55"S AGD66, west to longitude 140°27'40"E AGD66, south to latitude 28°29'10"S AGD66, west to longitude 140°27'10"E AGD66, north to latitude 28°29'05"S AGD66, west to longitude 140°26'35"E AGD66, north to latitude 28°28'00"S AGD66, east to longitude 140°26'50"E AGD66, north to latitude 28°27'30"S AGD66, east to longitude 140°27'20"E AGD66 and north to the point of commencement.

AREA: 16.03 square kilometres approximately

TERMS AND CONDITIONS

By agreement between the Minister and the Producers pursuant to Section 9 of the Cooper Basin (Ratification) Act, 1975 and Clause 6(1) of the Indenture scheduled thereto, and pursuant to the provisions of the *Petroleum Act 2000* the following terms and conditions apply to this Licence:-

1. Payment of Fees and Royalty

The Licensees hereby covenant with the Minister that they will make payment of the annual fee and royalty provided under the *Petroleum Act 2000* and will subject to the provisions of the *Cooper Basin (Ratification) Act 1975* comply with the provisions of the *Petroleum Act 2000* and with all Regulations for the time being in force under that Act and with any directions given by the Minister or any other person pursuant to that Act or the said Regulations.

2. Sublicensing

The Minister hereby gives and records his consent to the grant by the Licensees of one or more Sub-Licences pursuant to the provisions of the *Cooper Basin (Ratification) Act 1975* in the form of or to the effect set out in the Schedule hereto.

3. Joint interests

It is hereby acknowledged and agreed that the Licensees own and hold the following undivided interests respectively in and under this Licence:-

Santos	Forty point seven zero percent	(40.70%)
Delhi	Twenty point two one percent	(20.21%)
Origin Energy	Thirteen point one nine percent	(13.19%)
Vamgas	Eight point five one percent	(8.51%)
Novus	Four point seven five percent	(4.75%)
Bridge Oil	Three point nine nine percent	(3.99%)
Alliance	Three point nine seven percent	(3.97%)
Basin	Two point one zero percent	(2.10%)
Reef	One point nine seven percent	(1.97%)
Santos Petroleum	Zero point four zero percent	(0.40%)
Santos (BOL)	Zero point two one percent	(0.21%)

PROVIDED THAT nothing in this Clause contained shall in any way affect or derogate from the rights, duties and liabilities of the Licensees (as determined pursuant to the Indenture as defined in the *Cooper Basin (Ratification) Act 1975* and the *Petroleum Act 2000*) to the Minister under this Licence **AND PROVIDED FURTHER THAT** as between the Licensees the undivided interests so owned and held by the Licensees shall be subject to the provisions of a Joint Operating Agreement dated the 17th day of October 1973 to which the Licensees are parties and as the same has been amended and as may hereafter be amended from time to time.

4. The Licensees shall comply with its obligations under the Deed dated 1st May 2001 between the Minister for Minerals and Energy and Santos Limited, Delhi Petroleum Pty Ltd, Origin Energy Resources Limited, Vamgas Pty Ltd, Novus (Aust) Resources NL, Alliance Petroleum Australia Pty Ltd, Reef Oil Pty Ltd, Santos Petroleum Pty Ltd, Bridge Oil Development Pty Ltd, Santos (BOL) Pty Ltd, and Basin Oil Pty Ltd.

SIGNED by the DIRECTOR PETROLEUM, DEPARTMENT OF PRIMARY INDUSTRIES AND RESOURCES at Adelaide

this 15th day of May 2001

Robert Anthony Laws
Director Petroleum
Office of Minerals and Energy Resources
Department of Primary Industries and Resources
Delegate of the Minister Minerals and Energy

SIGNED, SEALED AND DELIVERED)
by the said LICENSEES at Adelaide)
this 11th day of May 2001)

Executed on behalf of SANTOS LIMITED, ALLIANCE)
PETROLEUM AUSTRALIA PTY LTD, REEF OIL)
PTY LTD, SANTOS (BOL) PTY LTD, BRIDGE OIL)
DEVELOPMENTS PTY LTD, SANTOS PETROLEUM)
PTY LTD and VAMGAS PTY LTD, respectively by being)
SIGNED, SEALED AND DELIVERED by its duly)
authorised Attorney under Power of Attorney who)
hereby states that he has received no notice of)
revocation of the Power of Attorney affecting such)
appointment, in the presence of:)

(Witness)

EXECUTED for and on behalf of
DELHI PETROLEUM PTY LTD
by its duly authorised attorney
in the presence of:

[Handwritten Signature]
.....

Signature of Witness

[Handwritten Signature]
.....

Signature of Attorney

[Handwritten Signature]
.....

Name of Witness

IAN WILLIAM ANGUS
.....

Name of Attorney

~~THE COMMON SEAL of ORIGIN ENERGY
RESOURCES LIMITED was hereunto
affixed in the presence of:~~

Signed for and on behalf of
ORIGIN ENERGY RESOURCES LIMITED
by JOHN STEPHEN RODDA
its Attorney pursuant to Power of Attorney
dated 5th MARCH 2001
the Attorney declares that the Attorney has
not received any notice of revocation of such
Power of Attorney, in the presence of:

[Handwritten Signature]
.....
(Director) SIGNATURE OF ATTORNEY

(Secretary)

[Handwritten Signature]
.....
SIGNATURE OF WITNESS

[Handwritten Signature]
.....
NAME OF WITNESS

THE COMMON SEAL of NOVUS AUSTRALIA
RESOURCES NL was hereunto affixed in
the presence of:



[Handwritten Signature]
.....
(Director)

[Handwritten Signature]
.....
Elaine M Connor (Secretary)
Company Secretary

THE COMMON SEAL of BASIN OIL PTY LTD
was hereunto affixed in the presence of:

[Handwritten Signature]
.....
(Director) Graham Dwyer

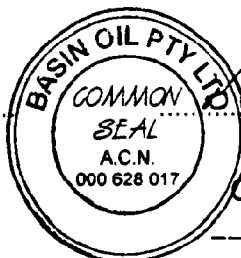

[Handwritten Signature]
.....
(Secretary) Michael Flanagan
Commercial Manager

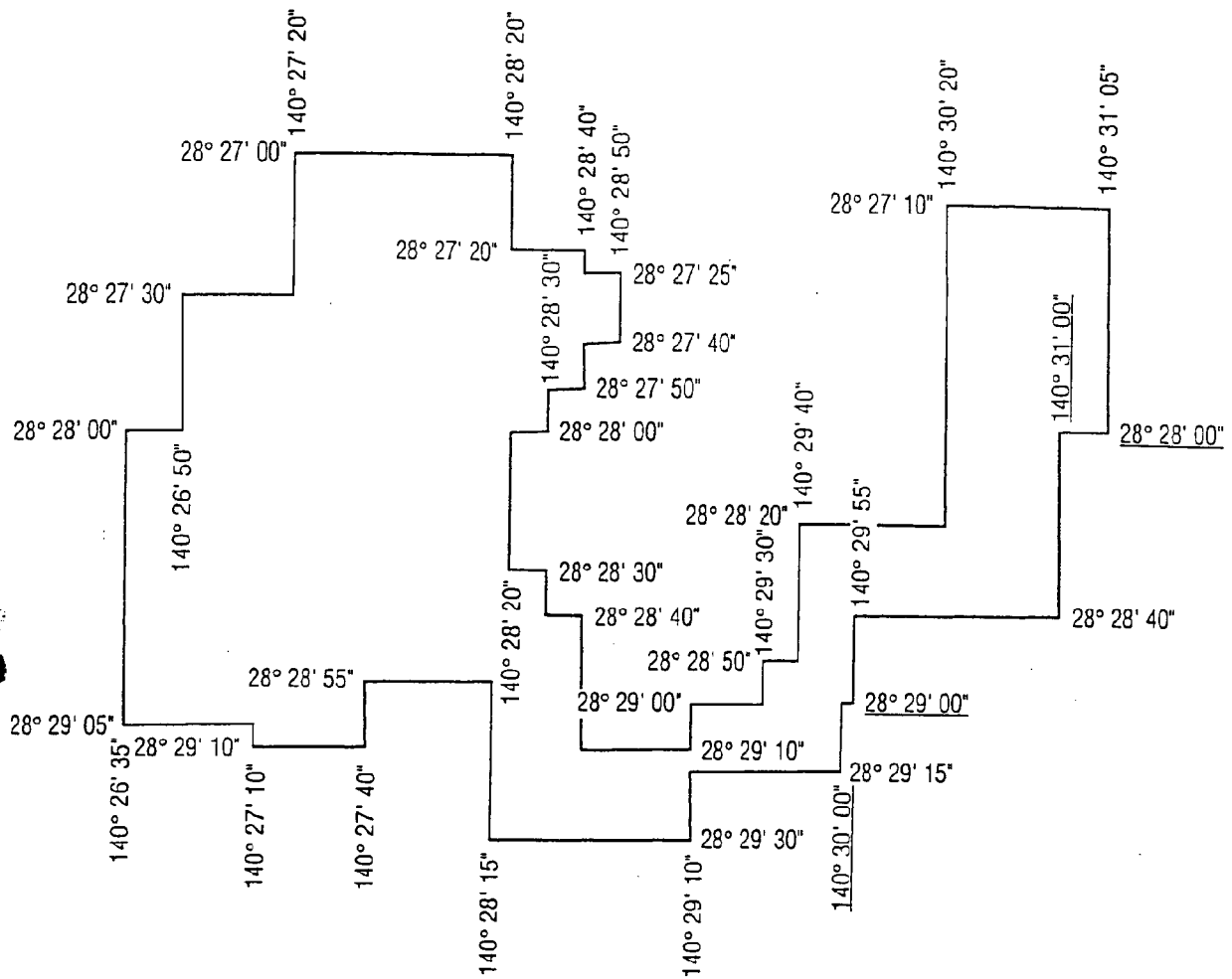

SCALE 1 : 50 000

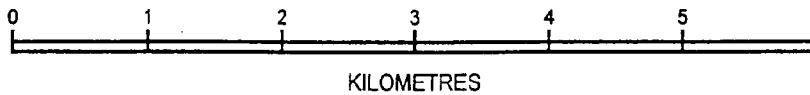

All the within latitudes and longitudes are geodetic and expressed in terms of the Australian Geodetic Datum as defined on page 4984 of Commonwealth Gazette number 84 dated 6 October 1966, except those latitudes and longitudes underlined which are expressed in terms of Clarke 1858 Spheroid (Transverse Mercator Projection)

GREATER MCKINLAY FIELD PRODUCTION LICENCE NO. 188

THE SCHEDULE HEREINBEFORE REFERRED TO

THIS DEED OF SUB-LICENCE made the day of 20

BETWEEN:

ALLIANCE PETROLEUM AUSTRALIA PTY. LTD. A.B.N 60 004 559 951 whose registered office is situated at Level 29, Santos House, 91 King William Street, Adelaide in the State of South Australia (hereinafter sometimes called '**Alliance**' which expression where the context requires or permits shall include its successors and assigns);

AND

BASIN OIL PTY LTD ABN 36 000 628 017 whose registered office is situated at Level 29, St Martins Tower, 44 St Georges Terrace, Perth in the State of Western Australia (hereinafter sometimes called '**Basin**' which expression where the context requires or permits shall include its successors and assigns);

AND

ORIGIN ENERGY RESOURCES LIMITED ABN 66 007 845 338 whose registered office is situated at Level 12, 1 King William Street, Adelaide in the State of South Australia (hereinafter sometimes called '**Origin**' which expression where the context requires or permits shall include its successors and assigns);

AND

BRIDGE OIL DEVELOPMENTS PTY LIMITED ABN 30 001 152 049 whose registered office is situated at Level 29, Santos House, 91 King William Street, Adelaide in the State of South Australia (hereinafter sometimes called '**BOD**' which expression where the context requires or permits shall include its successors and assigns);

AND

DELHI PETROLEUM PTY LTD ABN 66 007 854 686 whose registered office is situated at 12 Riverside Quay, Southbank in the State of Victoria (hereinafter sometimes called '**Delhi**' which expression where the context requires or permits shall include its successors and assigns);

AND

NOVUS (AUST) RESOURCES NL ABN 75 004 761 255 whose registered office is situated at Level 9, 321 Kent Street, Sydney in the State of New South Wales (hereinafter sometimes called '**Novus**' which expression where the context requires or permits shall include its successors and assigns);

AND

REEF OIL PTY LTD ABN 70 006 646 800 whose registered office is situated at Level 29, Santos House, 91 King William Street, Adelaide in the State of South Australia (hereinafter sometimes called '**Reef**' which expression where the context requires or permits shall include its successors and assigns);

AND

SANTOS LIMITED ABN 80 007 550 923 whose registered office is situated at Level 29, Santos House, 91 King William Street, Adelaide in the State of South Australia (hereinafter sometimes called '**Santos**' which expression where the context requires or permits shall include its successors and assigns);

AND

SANTOS (BOL) PTY LTD ABN 35 000 670 575 whose registered office is situated at Level 29, Santos House, 91 King William Street, Adelaide in the State of South Australia (hereinafter sometimes called '**Santos (BOL)**' which expression where the context requires or permits shall include its successors and assigns);

AND

SANTOS PETROLEUM PTY LTD ABN 95 000 146 369 whose registered office is situated at Level 29, Santos House, 91 King William Street, Adelaide in the State of South Australia (hereinafter sometimes called '**Santos Petroleum**' which expression where the context requires or permits shall include its successors and assigns);

AND

VAMGAS PTY LTD ABN 76 006 245 110 whose registered office is situated at Level 29, Santos House, 91 King William Street, Adelaide in the State of South Australia (hereinafter sometimes called '**Vamgas**' which expression where the context requires or permits shall include its successors and assigns);

the said companies being hereinafter collectively called '**the Licensors**' which expression where the context requires or permits shall include their respective successors and assigns);

OF THE ONE PART

AND

the said companies being hereinafter collectively called '**the Licensees**' which expression where the context requires or permits shall include their respective successors and assigns);

OF THE OTHER PART

WHEREAS:-

- A. The Licensors are the holders of Production Licence No. [DATE OF LICENCE] granted by the Minister for Primary Industries and Resources of the State of South Australia pursuant to the powers in the *Petroleum Act 2000* and the *Cooper Basin (Ratification) Act 1975* over certain land in the State of South Australia as more particularly described in the said Production Licence No. [.....].

- B. The Licensees are parties to an agreement made as of the 1st day of January 1975 known as the South Australian Cooper Basin Unit Agreement (hereinafter and as the same has been and may hereafter be amended from time to time referred to as '**the Unit Agreement**') relating inter alia to the development and production of petroleum from that sub-surface portion of the area comprised in the said Production Licence No. [] as the same is more particularly described in the Schedule hereto.
- C. The Licensors with the consent of the Minister for Primary Industries and Resources of the State of South Australia have agreed to grant and the Licensees have agreed to accept a Sub-Licence to exercise the rights specified in Clause 1 immediately following hereof upon the conditions specified in Clauses 2, 3, 4 and 5 immediately following hereof.

NOW THIS DEED WITNESSETH AS FOLLOWS:-

1. The Licensors with the consent of the Minister for Primary Industries and Resources of the State of South Australia hereby grant to each of the Licensees severally the exclusive rights commencing and inclusive of subject to the provisions of this Deed of Sub-Licence to:-
- (a) conduct operations for the appraisal and production of petroleum from such sub-surface portion of the area comprised in the said Production Licence No. [.....] as is more particularly described in the Schedule hereto (hereinafter referred to as '**the Unitized Zone**') and subject to Clause 2 hereof to own all petroleum extracted or released therefrom; and
- (b) construct and maintain upon the land comprised in the said Production Licence No. [] all such facilities as the Licensors are entitled to construct and maintain thereon pursuant to Section 34 of the *Petroleum Act 2000* or the *Cooper Basin (Ratification) Act 1975* (or both) of the State of South Australia and as are necessary from time to time for the full enjoyment of the rights granted pursuant to Clause 1(a) hereof.
2. Each of the Licensees hereby expressly acknowledges, covenants and agrees with the Licensors and with each of the other Licensees that in the exercise of

- exclusive rights granted pursuant to Clause 1 hereof each Licensee shall at all times act subject to and in accordance with the provisions of the Unit Agreement (and in particular to the provisions of Clause 13.01 thereof which refers to an overriding royalty in favour of Santos) and that such rights shall entitle each Licensee to extract or release from the Unitized Zone so much of the petroleum within the Unitized Zone as such Licensee is entitled to from time to time in accordance with its Gas Unit Participation, Ethane Unit Participation, Propane Unit Participation, Butane Unit Participation, Condensate Unit Participation, Crude Oil Unit Participation and its Additional Plant Products Unit Participation or Participations in accordance with the provisions of the Unit Agreement.
3. The Licensees hereby jointly and severally covenant with the Licensors that they will make payment in accordance with the Unit Agreement, as amended, of the royalty referred to in the *Cooper Basin(Ratification) Act 1975* in respect to the production referred to in Clause 2 hereof and subject to the provisions of the *Cooper Basin (Ratification) Act 1975* make payment in accordance with the Unit Agreement of the yearly rent provided under the said *Petroleum Act 2000* and will subject as aforesaid comply with the provisions of the *Petroleum Act 2000* and with all Regulations for the time being in force under that Act and with any directions given by the Minister for Primary Industries and Resources or any other person pursuant to that Act or the said Regulations and the Licensees hereby further jointly and severally covenant with the Licensors not to do any act or thing or make any omission which would cause the Licensors to be in breach or default of the provisions of the said Production Licence No. [.....] or of the provisions of the said *Petroleum Act 2000* or of any regulation for the time being in force under that Act or with any direction given by the Minister for Primary Industries and Resources or any other person pursuant to that Act or the said Regulations.
 4. Subject to the due compliance by the Licensees with their obligations under this Deed of Sub-Licence the Licensors hereby covenant with the Licensees to perform the covenants and obligations on the part of the Licensors contained in the said Production Licence No. [].

5. The rights of the Licensees or any of them granted pursuant to the foregoing provisions of this Deed of Sub-Licence shall not be sold assigned transferred leased sub-let mortgaged pledged charged encumbered or otherwise disposed of other than subject to and in accordance with the provisions of Article XV of the Unit Agreement and subject to Section 113 of the said *Petroleum Act 2000* and Clause 14.2 of the Indenture as defined in the *Cooper Basin (Ratification) Act 1975*.

IN WITNESS WHEREOF the Parties hereto sign seal and deliver the foregoing presents and have hereunto set their respective hands and seals as of the day and year first above written.

Executed on behalf of)
ALLIANCE PETROLEUM AUSTRALIA)
PTY LTD, BRIDGE OIL DEVELOPMENTS)
PTY LTD, REEF OIL PTY LTD, SANTOS)
LIMITED, SANTOS (BOL) PTY LTD, SANTOS)
PETROLEUM PTY LTD and VAMGAS PTY LTD)
respectively by being **SIGNED, SEALED AND**)
DELIVERED by its duly authorised Attorney under)
Power of Attorney who hereby states that he has)
received no notice of revocation of the Power of)
Attorney effecting such appointment, in the)
presence of:)

.....
Witness

THE COMMON SEAL of
BASIN OIL PTY LTD was hereunto affixed)
in the presence of:)

.....
Director

.....
Secretary

THE COMMON SEAL of)
ORIGIN ENERGY RESOURCES LTD was)
hereunto affixed in the presence of:)

.....
Director

.....
Secretary

EXECUTED for and on behalf of)
DELHI PETROLEUM PTY LTD)
by its duly authorised attorney)
in the presence of:)

.....
Signature of Witness

.....
Signature of Attorney

.....
Name of Witness

.....
Name of Attorney

THE COMMON SEAL of)
NOVUS AUSTRALIA RESOURCES NL was hereunto)
affixed in the presence of)

.....
Director

.....
Secretary

SCHEDULE

PRODUCTION LICENCE NO. ...

DESCRIPTION OF AREA

All that part of the State of South Australia, bounded as follows:-

AREA: square kilometres approximately.

DATED 1st DAY OF May 2001

DEED

BETWEEN

MINISTER FOR MINERALS AND ENERGY
("MINISTER")

AND

ALLIANCE PETROLEUM AUSTRALIA PTY LTD
A.B.N. 60 004 559 951

BASIN OIL PTY LTD
A.B.N. 36 000 628 017

ORIGIN ENERGY RESOURCES LIMITED
A.B.N. 66 007 845 338

BRIDGE OIL DEVELOPMENTS PTY LTD
A.B.N. 30 001 152 049

DELHI PETROLEUM PTY LTD
A.B.N. 65 007 854 686

NOVUS AUSTRALIA RESOURCES NL
A.B.N. 75 004 761 255

REEF OIL PTY LTD
A.B.N. 70 000 646 800

SANTOS LIMITED
A.B.N. 80 007 550 923

SANTOS (BOL) PTY LTD
A.B.N. 35 000 146 575

SANTOS PETROLEUM PTY LTD
A.B.N. 95 000 146 369

VAMGAS PTY LTD
A.B.N. 76 006 245 110
("LICENCEES")

THIS DEED is dated the 1st day of May 2001.

BETWEEN:

MINISTER FOR MINERALS AND ENERGY a body corporate pursuant to the Administrative Arrangements Act, 1994 (SA) and whose office is situated at 12th Floor, 211 Victoria Square, Adelaide, 5000 in the State of South Australia ("**Minister**")

AND

ALLIANCE PETROLEUM AUSTRALIA PTY LTD A.B.N. 60 004 559 951 of Level 29, 91 King William Street, Adelaide, South Australia, **BASIN OIL PTY LTD** A.B.N. 36 000 628 017 of c/- OMV Australia Pty Ltd, Level 29 St Martins Tower, 44 St Georges Terrace, Perth, Western Australia, **ORIGIN ENERGY RESOURCES LIMITED** A.B.N. 66 007 845 338 of Level 6, 1 King William Street, Adelaide, South Australia, **BRIDGE OIL DEVELOPMENTS PTY LTD** A.B.N. 30 001 152 049 of Level 29, 91 King William Street, Adelaide, South Australia, **DELHI PETROLEUM PTY LTD** A.B.N. 65 007 854 686 of c/- Esso Australia Ltd., Esso House, 12 Riverside Quay, Southbank, Victoria, **NOVUS AUSTRALIA RESOURCES NL** A.B.N. 75 004 761 255 of Level 19, 321 Kent Street, Sydney, New South Wales, **REEF OIL PTY LTD** A.B.N. 70 000 646 800 of Level 29, 91 King William Street, Adelaide, South Australia, **SANTOS LIMITED** A.B.N. 80 007 550 923 of Level 29, 91 King William Street, Adelaide, South Australia, **SANTOS (BOL) PTY LTD** A.B.N. 35 000 670 575 of Level 29, 91 King William Street, Adelaide, South Australia, **SANTOS PETROLEUM PTY LTD** A.B.N. 000 146 369 of Level 29, 91 King William Street, Adelaide, South Australia, **VAMGAS PTY LTD** A.B.N. 006 245 100 of Level 29, 91 King William Street, Adelaide, South Australia ("**Licensees**").

OPERATIVE PROVISIONS

1. Pursuant to the Minister's offers to grant the production licences identified in the attached schedule (each a "Licence") to the Licensees, the Licensees hereby agree and undertake to:

1.1 make application to the Minister to surrender such part (if any) of each licensed area ("Surrendered Areas") on or before the date specified for each Licence in the fourth column of the schedule so that the remaining area of each Licence is no greater than the combined total of:

- (a) the area under which proved and probable reserves of petroleum occur including areas under which proved and probable reserves of petroleum can be demonstrated to have occurred prior to the initiation of production from the field; and
- (b) surrounding land identified by the Licensees equal in size to the area mentioned in 1.1(a);

1.2 surrender the least number of separate areas where technically appropriate and with regard to good petroleum field practice and defined by parallels of latitude and meridians of longitude expressed in the Geocentric Datum of Australia (GDA), 1994.

2. The Parties (which in this Deed shall mean the Minister and each of the Licensees) agree that the Licensees will have no right to retain title over the Surrendered Areas as a retention licence under any legislation which allows for such licences.

3. If the Minister following a technical review with the Licensees forms the view that the area or areas identified by the Licensees under 1.1(a) is or are not technically justified having regard to the matters referred to at 3.1 and 3.2, the Parties agree to appoint a suitably qualified expert (whose decision shall be final and binding), the costs of whom shall be borne equally between the Minister on the one hand and the Licensees on the other, to determine such area or areas. In the event the Parties fail to agree on the appointment of a suitably qualified expert, the expert shall be appointed by the President of the Society of Petroleum Engineers or his or her nominee. The expert shall, in making his determination, have regard to:

3.1 the 1997 SPE/WPC Reserve Definitions; and

- 3.2 PIRSA's "Department of Mines and Energy, South Australia Report Book 91/96".
- 4. This Deed may not be amended or varied except by the written agreement of all Parties.
- 5. This Deed may be executed in any number of counterparts each of which is taken to be an original. All of those counterparts taken together constitute one instrument.
- 6. This Deed shall be governed and construed in all respects in accordance with the laws of South Australia and the Parties agree to submit to the exclusive jurisdiction of the courts of South Australia in respect of all disputes arising under or relating to this Deed.

EXECUTED AS A DEED

THE COMMON SEAL of the **MINISTER FOR MINERALS AND ENERGY** was hereunto affixed in the presence of:



[Handwritten signature of Wayne Anthony Matthew]

The Honourable Wayne Anthony Matthew MP
Minister for Minerals and Energy

[Handwritten signature of witness]

Witness
Print Name: *M. Coletta*

SIGNED, SEALED AND DELIVERED by the said
LICENSEES at
this day of 2001

Executed on behalf of ALLIANCE PETROLEUM AUSTRALIA PTY LTD, BRIDGE OIL DEVELOPMENTS PTY LTD, REEF OIL PTY LTD, SANTOS LIMITED, SANTOS (BOL) PTY LTD, SANTOS PETROLEUM PTY LTD and VAMGAS PTY LTD respectively by being SIGNED, SEALED AND DELIVERED by its duly authorised Attorney under Power of Attorney who hereby states that he has received no notice of revocation of the Power of Attorney effecting such appointment, in the Presence of:

[Handwritten signature]

[Handwritten signature: Karen McManus]

Witness
Print Name: KAREN McMANUS
Executive Secretary

THE COMMON SEAL of the BASIN OIL PTY LTD was hereunto affixed in the presence of:

Director
Print Name: Graham Dwyer

Secretary
Print Name: Michael Flanagan
Commercial Manager



THE COMMON SEAL of the ORIGIN ENERGY RESOURCES LTD was hereunto affixed in the presence of:

SIGNED FOR AND ON BEHALF OF ORIGIN ENERGY RESOURCES LIMITED BY JOHN STEPHEN LODDA, ITS ATTORNEY PURSUANT TO POWER OF ATTORNEY DATED 5 MARCH 2001, THE ATTORNEY DECLARES THAT THE ATTORNEY HAS NOT RECEIVED ANY NOTICE OF REVOCATION OF SUCH POWER OF ATTORNEY, IN THE PRESENCE OF;

[Handwritten signature]

Director
Print Name:

Secretary
Print Name: JOHN F. ANGUS

[Handwritten signature: John F. Angus]

EXECUTED for and on behalf of DELHI
PETROLEUM PTY LTD by its duly
authorised attorney in the presence of:

)
)
)

[Handwritten Signature]

Signature of Witness

RS Nurse

Name of Witness

[Handwritten Signature]

Signature of Attorney

IAN WILLIAM ANGUS

Name of Attorney

THE COMMON SEAL of NOVUS AUSTRALIA
RESOURCES N.L. was hereunto affixed in accordance with its
constitution in the presence of:

)
)
)

[Handwritten Signature]

Director

Print Name: *GRAHAM B. MONK*

[Handwritten Signature]

Secretary

Print Name:

Elaine M Connor
Company Secretary



THE SCHEDULE

PL NUMBER	PL NAME	AREA OF LICENCE (Km ²)	DATE
COLUMN 1	COLUMN 2	COLUMN 3	COLUMN 4
171	Atreides Extension	23.56	5 years from grant
172	Greater Moomba Big Lake (Yalcumma) Extension	126.8	5 years from grant
173	Boongala – Kerna Ridge Extension	134.78	5 years from grant
175	Caladan North Extension	45.92	5 years from grant
181	Grenache	18.44	5 years from grant
183	Kanowana South	15.24	5 years from grant
185	Greater Kirralee Extension	33.65	5 years from grant
186	Kobari	21.45	5 years from grant
188	McKinlay Extension	16.03	5 years from grant
189	Greater Moomba Big Lake (Bauhaus-Allunga) Extension	259.73	5 years from grant
190	Greater Moomba Big Lake (Merlot/Boobook) Extension	231.91	5 years from grant
192	Pirraminta-Haloragis	23.36	5 years from grant
196	Tirrawarra-Moorari- Woolkina Extension (PE)	110.87	5 years from grant
198	Wilpinnie Extension	24.58	5 years from grant

In accordance with Section 117 of the *Petroleum Act 2000* (Act) this document forms part of 'The Commercial Register'.

Section 118 of the Act provides for the following:

Authority to search register

(1) A person is entitled to have access to the material included in the commercial register, on payment of the prescribed inspection fee, if the access is authorised by—

- (a) a person who has a legal or equitable interest in the relevant licence or registered dealing; or
- (b) (b) the Minister.

(2) The Minister must not authorise access under subsection (1)(b) unless the Minister has consulted with the licensee to whom the material relates and is satisfied that access should be authorised in the public interest.

FOR FURTHER INFORMATION PLEASE CONTACT:

Department of State Development
Energy Resources Division
GPO Box 320,
Adelaide SA 5001
(08) 8463 3204